

PROFESSIONAL POWER TOOLS

Professional Manufacturer since 1985

ISO-9001:2008 CERTIFICATED



Tranmax Machinery Co., Ltd.

www.tranmax.com



TRANMAX
Tranmax Machinery



Table of Contents

6 Air Impact Wrenches	52 Industrial Air Screwdrivers
7 Aluminum Impacts	
14 Composite Impacts	59 Air Hammers and Needle Scalers
16 Stubby 1/2" Impact	60 Air Hammers
	62 Air Needle Scalers
17 Industrial Impact Tools - TDW series	
19 Oil-Bathed Type	64 Special Tools
	65 Caulking Guns
20 Air Ratchet Wrenches	65 Grease Guns
21 Aluminum Ratchets	66 Concrete Breakers
22 Composite Ratchets	67 Riveters and Nut Setters
24 Air Grinders and Cutting Tools	68 Digital Torque Wrenches
25 Angle Grinders	
27 Die Grinders	70 Accessories
32 Composite Grinders	70 Maintenance Parts
35 Cutting Tools	
37 Air Finishing Tools	
38 Sanders	
45 Air Drills and Screwdrivers	
46 Air Drills	
49 Air Screwdrivers	





About TRANMAX

Established in 1985, Tranmax Machinery Co., Ltd. has devoted itself to manufacturing and exporting high quality pneumatic tools for professional applications. Over 30 years of experience in developing Impact Wrenches, Ratchet Wrenches, Screwdrivers, Sanders, Grinders, Drills, etc., Tranmax has successfully earned popularity and a sound reputation in world-wide markets, especially in Germany, Holland, France, Italy, England and the United States. New innovations and improvements are persistently made to meet market trends and demands. Reliable products and customer satisfaction are what we always pursue. We welcome you to develop a mutually beneficial relationship with us on a long-term basis.



ISO 9001:2008 Certificate

Air Tools and Pipe Fitting System

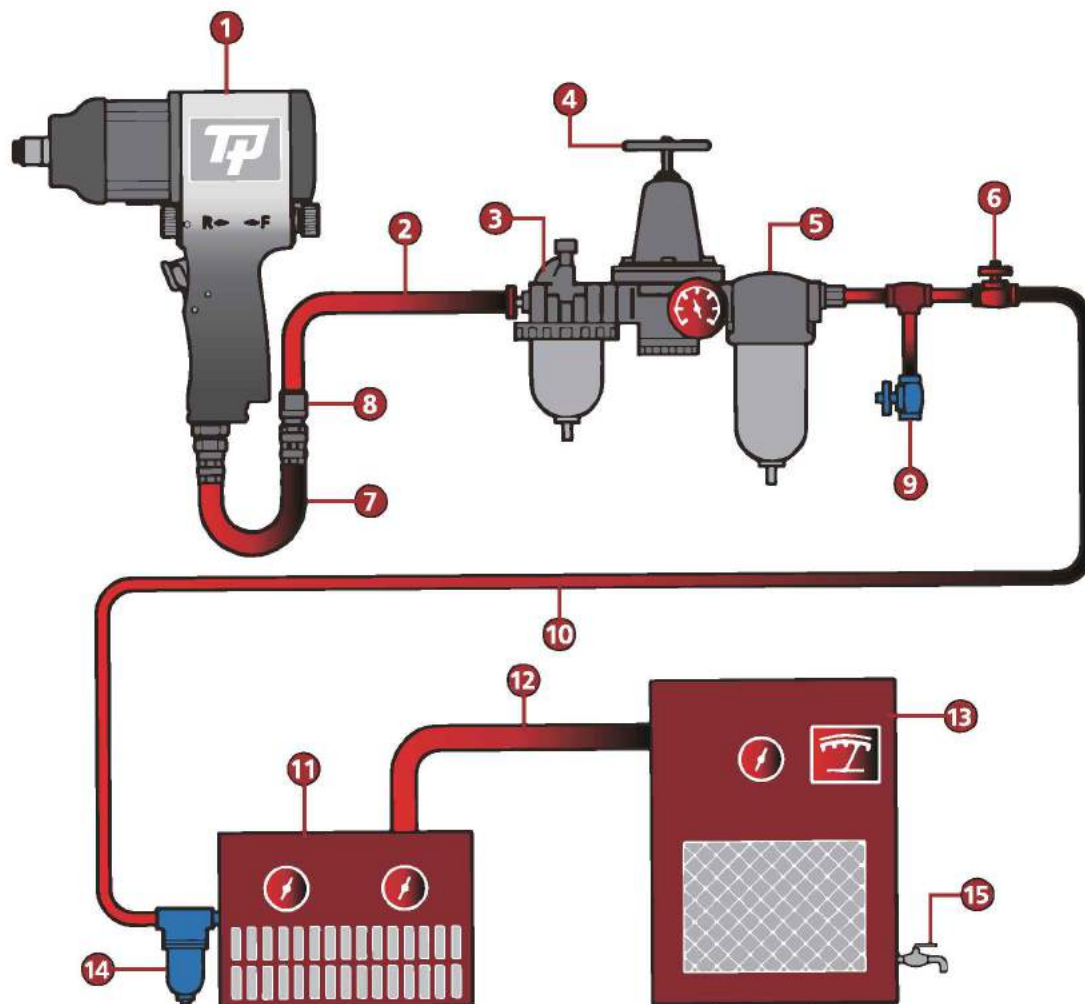

- 1. Air tool
- 2. Air hose 3/8"
- 3. Oiler
- 4. Pressure regulator
- 5. Filter



- 6. Shut off valve
- 7. Lead hose
- 8. Coupler body and connector
- 9. Drain daily
- 10. 1/2" or larger pipe and fitting

- 11. Air dryer
- 12. 1" or larger pipe and fitting
- 13. Air compressor
- 14. Auto drain
- 15. Drain daily

CAUTION

1. To protect air tools, we strongly recommend that you install a pneumatic filter, moisture separator, regulator and lubricator between the air supply and air tools.
2. Please check to see if there is too much moisture in the pipe and the air compressor is drained daily.
3. Be sure to fill in SAE#10 lubricating oil into the air inlet before using air tools.
4. Before using air tools, please make sure if the air pressure is proper.

Periodic Maintenance and Inspection

Items	Description	Inspection	Daily	Weekly	Remarks
1	Check the condition of air line accessories, and drain out the water from the separators and line to keep the air supply system clean and dry.		•		All Air Tools
2	Always keep the air pressure at 90 psi (6.3kg/cm ²) for maximum tool performance and take your reading while the tool is running.		•		All Air Tools
3	Use the proper couplers, nipples, hoses, pipes and fitting.		•	•	All Air Tools
4	Check that the quick change couplers is in secure connection and in good order.		•	•	All Air Tools
5	Keep the tools properly lubricated to prevent wear and rust.		•	•	All Air Tools
6	When tools are not in use, clean and lubricate them, then store them in a clean and dry place.		•		All Air Tools
7	Always use safety goggles or a face shield when operating air tools. Never wear loose clothing that might get caught in the tool and cause injuries.		•		All Air Tools
8	When installing whip hoses or quick coupler directly into the tool, Use a liquid pipe sealant to prevent damage to the housing.		•		All Air Tools
9	Always make sure that the impact wrench socket is properly retained to prevent injuries, Use impact-type socket only.		•		Wrench
10	If an air wrench fails to loosen a bolt in five(5) seconds, use a larger wrench and apply the penetrating oil before using the wrench.				Wrench
11	Check the clutch lubricant regularly, typically a 3/8" air wrench should have 3/8oz. of lubricant in its clutch mechanism.		•		Wrench
12	Always use proper wheel and pad for sanding and keep the secure connector in good order.		•	•	Sander Grinder
13	Never use a sander as a grinder, Sanders are intended for sanding only.		•		Sander Grinder
14	Always use accessories with a rated speed equal to or greater than the sander's speed.		•	•	Sander Grinder
15	Clean and lubricate the chuck jaws periodically to prolong concentricity.		•		Drill
16	To avoid the danger of breakage from high breakthrough torque, use the properly sharpened twist drills and reamers, and select proper drill speed.		•		Drill
17	Start drilling at low speed and gradually increase power. Avoid kick-back by easing up at breakthrough.		•		Drill



Super Hammer

1. Hammer Cage
2. New Hammer (Patented)
3. Hammer Pin
4. Anvil

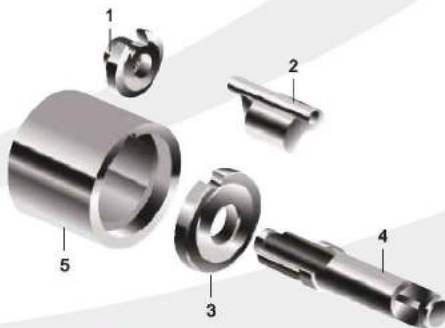

Pin Hammer

1. Cam
2. Pin Hammer
3. Cage Cover
4. Anvil
5. Hammer Cage

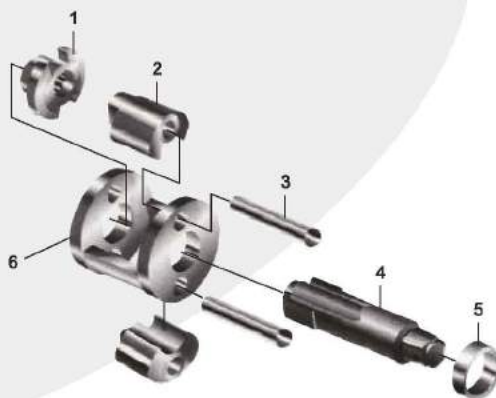

Double Hammer

1. Cage
2. Hammer Dog
3. Hammer Pin
4. Anvil
5. Anvil Bushing
6. Hammer Cage

Impact Mechanisms

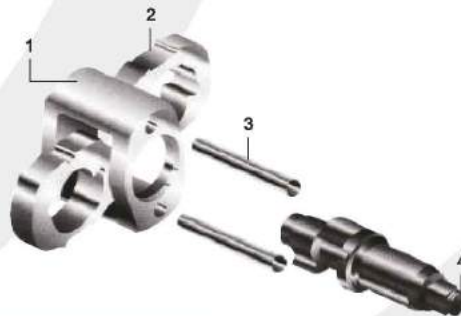

Twin Hammer

1. Hammer Cage
2. Hammer
3. Hammer Pin
4. Anvil

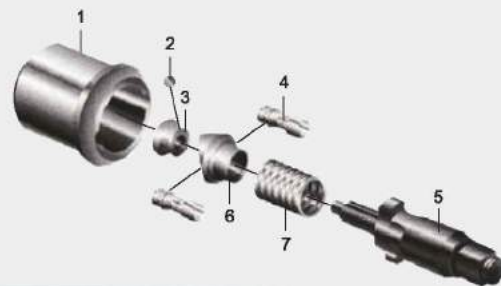

Pin Clutch

1. Hammer Cage
2. Steel Ball
3. Cam Foundation
4. Hammer Pin
5. Anvil
6. Cam
7. Spring

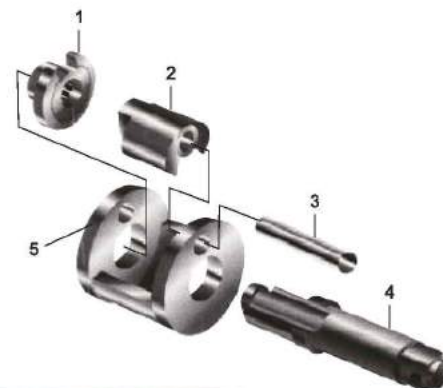

Rocking Dog

1. Cam
2. Hammer Dog
3. Hammer Pin
4. Anvil
5. Hammer Cage



Aluminum Impacts
Composite Impacts
Stubby 1/2" Impact

Air Impact Wrenches

The Air Impact Wrenches are one of the major products Tranmax offers. With the reliability and durability proven by customers and engineering expertise, they have been sold successfully on the market.

[Aluminum Impacts]



TPT-560B-SR-12
1-1/2" Impact Wrench, Super Hammer

TPT-560B-SR-12-L
with 9" (229mm) extended anvil

Model	SQ Drive	Free Speed	Max Torque Reverse		Net Weight		Overall Length		Noise Level	Average Air Cons. @ Load		Air Inlet NPTF	Hose Size	
	inch	rpm	ft-lb	Nm	lb	kg	inch	mm	dBA	cfm	L/min	inch	inch	mm
TPT-560B-SR-12	1-1/2	3,000	3,000	4,071	33.0	15.0	18.7	475	99	14.8	419	1/2	1/2	13
TPT-560B-SR-12-L	1-1/2	3,000	3,000	4,071	39.2	17.8	25.8	656	99	14.8	419	1/2	1/2	13
TPT-560B-SR-L	1	3,000	2,700	3,664	36.1	16.4	24.7	627	99	14.8	419	1/2	1/2	13
TPT-560B-SR	1	3,000	2,700	3,664	32.8	14.9	17.5	445	99	14.8	419	1/2	1/2	13
TPT-315PX-L	1	4,500	2,250	3,053	24.0	10.9	19.8	503	95	12	340	1/2	1/2	13
TPT-315PX	1	4,500	2,250	3,053	21.1	9.6	13.7	347	95	12	340	1/2	1/2	13



TPT-560B-SR-L
1" Impact Wrench, Super Hammer, 9" anvil

TPT-560B-SR
with 1" short anvil



TPT-315PX-L
1" Impact Wrench, Super Hammer, 9" anvil

TPT-315PX
with 1" short anvil



TPT-315P-SR-L

1" Impact Wrench, Super Hammer, 8" anvil

TPT-315P-SR

with 1" Short Anvil

Model	SQ Drive	Free Speed	Max Torque Reverse		Net Weight		Overall Length		Noise Level	Average Air Cons. @ Load		Air Inlet NPTF	Hose Size	
	inch	rpm	ft-lb	Nm	lb	kg	inch	mm	dBA	cfm	L/min	inch	inch	mm
TPT-315P-SR-L	1	4,000	2,200	2,985	23.5	10.7	21.1	536	95	12	340	1/2	1/2	13
TPT-315P-SR	1	4,000	2,200	2,985	20.5	9.3	15.0	380	95	12	340	1/2	1/2	13
TPT-315S-L	1	6,000	2,000	2,714	17.6	8.0	18.3	465	105	10.6	300	1/2	1/2	13
TPT-315S	1	6,000	2,000	2,714	15.2	6.9	11.9	303	105	10.6	300	1/2	1/2	13
TPT-318Q	1	5,500	1,900	2,578	15.0	6.8	10.6	269	96	11	311	1/2	1/2	13
TPT-318Q-L	1	5,500	1,900	2,578	17.4	7.9	17.0	431	96	11	311	1/2	1/2	13
TPT-318P-SR	1	3,500	2,000	2,714	21.1	9.6	11.8	300	96	11	311	1/2	1/2	13
TPT-318P-SR-L	1	3,500	2,000	2,714	24.0	10.9	18.0	456	96	11	311	1/2	1/2	13



TPT-315S-L

Compact 1" Impact Wrench, 8" Anvil, Super Hammer

TPT-315S

with 1" Short Anvil



TPT-318Q

Compact 1" Impact Wrench, Super Hammer

TPT-318Q-L

with 8" (203mm) extended anvil



TPT-318P-SR

1" Impact Wrench, Super Hammer

TPT-318P-SR-L

with 8" (203mm) extended anvil

[Aluminum Impacts]



TPT-275-8
1" Impact Wrench, Pin Clutch



TPT-275
3/4" Impact Wrench,
Pin Clutch
TPT-275-L
with 6" (152mm)
extended anvil



TPT-278D-SR
3/4" Impact Wrench,
Super Hammer
TPT-278D-SR-L
with 6" (152mm)
extended anvil

Model	SQ Drive	Free Speed	Max Torque Reverse		Net Weight		Overall Length		Noise Level	Average Air Cons. @ Load		Air Inlet NPTF	Hose Size	
	inch	rpm	ft-lb	Nm	lb	kg	inch	mm	dBA	cfm	L/min	inch	inch	mm
TPT-275-8	1	4,000	1,200	1,628	12.8	5.8	10.1	257	90	7.8	221	3/8	3/8	10
TPT-275	3/4	4,000	1,100	1,493	11.2	5.1	10.7	272	90	7.8	221	3/8	3/8	10
TPT-275-L	3/4	4,000	1,200	1,628	12.8	5.8	15.2	387	90	7.8	221	3/8	3/8	10
TPT-278D-SR	3/4	5,000	1,250	1,696	9.7	4.4	8.5	216	96	8	226	3/8	3/8	10
TPT-278D-SR-L	3/4	5,000	1,250	1,696	10.8	4.9	13.4	341	96	8	226	3/8	3/8	10

Model	SQ Drive	Free Speed	Max Torque Reverse		Net Weight		Overall Length		Noise Level	Average Air Cons. @ Load		Air Inlet NPTF	Hose Size	
	inch	rpm	ft-lb	Nm	lb	kg	inch	mm	dBA	cfm	L/min	inch	inch	mm
TPT-271-D	3/4	4,800	800	1,086	10.8	4.9	9.7	246	92	7.2	204	1/4	3/8	10
TPT-271-D-L	3/4	4,800	800	1,086	12.3	5.6	14.2	361	92	7.2	204	1/4	3/8	10
TPT-270	3/4	4,800	800	1,086	9.9	4.5	9.5	241	95	7.2	204	1/4	3/8	10
TPT-270-L	3/4	4,800	800	1,086	11.9	5.4	14.0	356	95	7.2	204	1/4	3/8	10
TPT-280	3/4	4,800	600	814	10.6	4.8	9.5	241	95	7.2	204	1/4	3/8	10
TPT-280-L	3/4	4,800	600	814	11.9	5.4	14.3	363	95	7.2	204	1/4	3/8	10



TPT-271-D
3/4" Impact Wrench,
Pin Clutch

TPT-271-D-L
with 6" (152mm)
extended anvil



TPT-270
3/4" Impact Wrench,
Pin Clutch

TPT-270-L
with 6" (152mm)
extended anvil



TPT-280
3/4" Impact Wrench,
Rocking Dog

TPT-280-L
with 6" (152mm)
extended anvil

[Aluminum Impacts]



TPT-300-D
1/2" Impact Wrench,
Pin Clutch

TPT-300-D-L
with 2"(51mm)
extended anvil



TPT-309
1/2" Impact Wrench,
Twin Hammer

TPT-309-L
with 2"(51mm)
extended anvil



TPT-303D-SR
1/2" Impact Wrench,
Super Hammer

TPT-303D-SR-L
with 2"(51mm)
extended anvil



TPT-303
1/2" Impact Wrench,
Twin Hammer

TPT-303-L
with 2"(51mm)
extended anvil

Model	SQ Drive	Free Speed	Max Torque Reverse		Net Weight		Overall Length		Noise Level	Average Air Cons. @ Load		Air Inlet NPTF	Hose Size	
	inch	rpm	ft-lb	Nm	lb	kg	inch	mm	dBA	cfm	L/min	inch	inch	mm
TPT-309	1/2	8,000	1,000	1,357	5.7	2.6	7.2	182	90	5.5	156	1/4	3/8	10
TPT-309-L	1/2	8,000	1,000	1,357	5.9	2.7	9.2	234	90	5.5	156	1/4	3/8	10
TPT-300-D	1/2	7,000	380	516	5.9	2.7	7.5	191	95	4.2	119	1/4	3/8	10
TPT-303D-SR	1/2	7,000	500	679	5.8	2.6	7.5	191	90	4.2	119	1/4	3/8	10
TPT-303D-SR-L	1/2	7,000	500	679	5.8	2.7	9.3	236	90	4.2	119	1/4	3/8	10
TPT-303	1/2	7,000	450	611	5.6	2.5	9.0	229	96	3.7	105	1/4	3/8	10
TPT-303-L	1/2	7,000	450	611	5.7	2.6	10.8	274	96	3.7	105	1/4	3/8	10



TPT-302
1/2" Impact Wrench,
Pin Clutch

TPT-302-L
with 2"(51mm)
extended anvil



TPT-304-E
1/2" Impact Wrench,
Pin Clutch

TPT-304-E-L
with 2"(51mm)
extended anvil



TPT-305
1/2" Impact Wrench,
Twin Hammer

TPT-305-L
with 2"(51mm)
extended anvil

Model	SQ Drive	Free Speed	Max Torque Reverse		Net Weight		Overall Length		Noise Level	Average Air Cons. @ Load		Air Inlet NPTF	Hose Size	
	inch	rpm	ft-lb	Nm	lb	kg	inch	mm	dBA	cfm	L/min	inch	inch	mm
TPT-302	1/2	7,000	320	434	5.0	2.3	7.3	185	96	3.7	105	1/4	3/8	10
TPT-302-L	1/2	7,000	320	434	5.3	2.4	9.3	236	96	3.7	105	1/4	3/8	10
TPT-304-E	1/2	7,000	450	611	5.5	2.5	7.3	185	86	4.2	119	1/4	3/8	10
TPT-305	1/2	7,000	500	679	5.8	2.6	7.6	193	86	4.6	130	1/4	3/8	10
TPT-305-L	1/2	7,000	500	679	5.9	2.7	9.4	238	86	4.6	130	1/4	3/8	10
TPT-305B	1/2	7,000	550	746	5.8	2.6	7.2	183	86	4.6	130	1/4	3/8	10
TPT-305B-L	1/2	7,000	550	746	5.9	2.7	9.0	228	86	4.6	130	1/4	3/8	10
TPT-306	1/2	8,000	400	543	5.3	2.4	7.8	198	86	4.6	130	1/4	3/8	10
TPT-306-L	1/2	8,000	400	543	5.5	2.5	9.8	249	86	4.6	130	1/4	3/8	10



TPT-305B
1/2" Impact Wrench,
Twin Hammer

TPT-305B-L
with 2"(51mm)
extended anvil



TPT-306
1/2" Impact Wrench,
Pin Clutch

TPT-306-L
with 2"(51mm)
extended anvil

[Aluminum Impacts]

**TPT-245**

3/8" Impact Wrench, Twin Hammer

TPT-245-4

with 1/2" square drive

**TPT-241**3/8" Impact Wrench,
Pin Clutch**TPT-241-L**with 3/8" (152mm)
extended anvil**TPT-241-4**

with 1/2" square drive

**TPT-243-SR**3/8" Impact Wrench,
Super Hammer**TPT-243-SR-4**

with 1/2" square drive

**TPT-230**3/8" Impact Wrench,
Double Hammer**TPT-247**3/8" Impact Wrench,
Jumbo Hammer

Model	SQ Drive	Free Speed	Max Torque Reverse		Net Weight		Overall Length		Noise Level	Average Air Cons. @ Load		Air Inlet NPTF	Hose Size	
	inch	rpm	ft-lb	Nm	lb	kg	inch	mm	dBA	cfm	L/min	inch	inch	mm
TPT-245	3/8	9,500	400	543	3.7	1.7	6.1	155	92	5	142	1/4	3/8	10
TPT-245-4	1/2	9,500	450	611	3.7	1.7	6.1	155	92	5	142	1/4	3/8	10
TPT-243-SR	3/8	10,000	280	380	3.7	1.7	6.0	152	91	2.8	79	1/4	3/8	10
TPT-243-SR-4	1/2	10,000	280	380	3.7	1.7	6.0	152	91	2.8	79	1/4	3/8	10
TPT-241	3/8	10,000	260	353	3.3	1.5	6.1	155	91	2.8	79	1/4	3/8	10
TPT-241-L	3/8	10,000	260	353	3.5	1.6	7.8	199	91	2.8	79	1/4	3/8	10
TPT-241-4	1/2	10,000	260	353	3.3	1.5	6.1	155	91	2.8	79	1/4	3/8	10
TPT-247	3/8	10,000	180	244	3.0	1.4	6.4	163	88	2.8	79	1/4	3/8	10
TPT-230	3/8	10,000	15	20	2.7	1.2	9.5	241	87	3	85	1/4	1/4	10

[Composite Impacts]

**TPT-318F-SR**1" Impact Wrench,
Super Hammer**TPT-318F-SR-L**

with 8" (203mm) extended anvil

**TPT-315G-SR-L**

1" Impact Wrench, Super Hammer

TPT-315G-SR

with 1" short anvil

**TPT-315F-SR-L**

1" Impact Wrench, Super Hammer

TPT-315F-SR

with 1" short anvil

Model	SQ Drive	Free Speed	Max Torque Reverse		Net Weight		Overall Length		Noise Level	Average Air Cons. @ Load		Air Inlet NPTF	Hose Size	
	inch	rpm	ft-lb	Nm	lb	kg	inch	mm	dBA	cfm	L/min	inch	inch	mm
TPT-318F-SR	1	4,000	1,800	2,443	15.8	7.2	9.9	251	95	14.5	410	1/2	1/2	13
TPT-318F-SR-L	1	4,000	1,800	2,443	18.0	8.2	16.6	421	95	14.5	410	1/2	1/2	13
TPT-315G-SR-L	1	4,000	2,000	2,714	22.8	10.4	21.7	556	95	14.5	410	1/2	1/2	13
TPT-315G-SR	1	4,000	2,000	2,714	20.0	9.1	15.7	400	95	14.5	410	1/2	1/2	13
TPT-315F-SR-L	1	4,000	1,800	2,443	18.7	8.5	21.7	550	95	14.5	410	1/2	1/2	13
TPT-315F-SR	1	4,000	2,000	2,714	16.7	7.6	15.6	395	95	14.5	410	1/2	1/2	13

[Composite Impacts]



TPT-243V-SR
3/8" Impact Wrench,
Super Hammer

TPT-243V-SR-4
with 1/2" square drive



TPT-278V-SR
3/4" Impact Wrench,
Super Hammer

TPT-278V-SR-L
with 6" (152mm)
extended anvil



TPT-305V-SR
1/2" Impact Wrench

TPT-305V-SR-L
with 2" (51mm) extended anvil



TPT-305W
1/2" Impact Wrench,
Super Hammer

TPT-305W-L
with 2" (51mm) extended anvil

Model	SQ Drive	Free Speed	Max Torque Reverse		Net Weight		Overall Length		Noise Level	Average Air Cons. @ Load		Air Inlet NPTF	Hose Size	
	inch	rpm	ft-lb	Nm	lb	kg	inch	mm	dBA	cfm	L/min	inch	inch	mm
TPT-243V-SR	3/8	12,000	320	434	2.6	1.2	6.5	165	89	7.4	209	1/4	3/8	10
TPT-243V-SR-4	1/2	12,000	320	434	2.6	1.2	6.5	165	89	7.4	209	1/4	3/8	10
TPT-278V-SR	3/4	5,500	1,400	1,900	7.5	3.4	9.0	229	90	9.5	269	3/8	3/8	10
TPT-278V-SR-L	3/4	5,500	1,400	1,900	8.6	3.9	14.0	355	90	9.5	269	3/8	3/8	10
TPT-305V-SR	1/2	7,500	1,000	1,357	4.4	2.0	7.6	193	90	10.2	289	1/4	3/8	10
TPT-305V-SR-L	1/2	7,500	1,000	1,357	4.6	2.1	9.4	238	90	10.2	289	1/4	3/8	10
TPT-305W	1/2	7,500	1,000	1,357	4.4	2.0	8.1	206	90	10.2	289	1/4	3/8	10
TPT-305W-L	1/2	7,500	1,000	1,357	4.6	2.1	10.1	256	90	10.2	289	1/4	3/8	10

[Stubby 1/2" Impact]

TPT-243D

Twin Hammer
Composite Housing
1/2" Impact Wrench



TPT-248D

3/8" Impact Wrench,
Super Hammer

TPT-248D-4

with 1/2" square drive



TPT-272D

3/4" Impact Wrench,
Super Hammer

TPT-272D-L

with 6" (152 mm)
extended anvil



TPT-307D

1/2" Impact Wrench,
Super Hammer

TPT-307D-L

with 2" (51 mm) extended anvil

Model	SQ Drive	Free Speed	Max Torque Reverse		Net Weight		Overall Length		Noise Level	Average Air Cons. @ Load		Air Inlet NPTF	Hose Size	
	inch	rpm	ft-lb	Nm	lb	kg	inch	mm	dBA	cfm	L/min	inch	inch	mm
TPT-243D	1/2	9,000	450	611	2.4	1.1	7.7	118	89.7	5.7	118	1/4	3/8	10
TPT-248D	3/8	10,000	450	611	2.9	1.3	6.7	170	89	5	142	1/4	3/8	10
TPT-248D-4	1/2	10,000	450	611	2.9	1.3	6.7	170	89	5	142	1/4	3/8	10
TPT-272D	3/4	5,000	1,550	2,103	8.1	3.7	9.3	236	90	7.8	221	3/8	3/8	10
TPT-272D-L	3/4	5,000	1,550	2,103	9.2	4.2	14.2	361	90	7.8	221	3/8	3/8	10
TPT-307D	1/2	7,500	1,290	1,751	4.6	2.1	7.7	196	90	5.7	161	1/4	3/8	10
TPT-307D-L	1/2	7,500	1,290	1,751	4.8	2.2	9.8	248	90	5.7	161	1/4	3/8	10



Industrial Impact Tools

■ TDW series

■ TDW series - Oil-Bathed Type

The TDW Impact Tools are specially made for industrial applications. The design of the durable mechanism enhances customers' productivity and operations giving them a favorable solution for long working hours on assembly lines.

[TDW series]



TDW-767
Industrial 1/4" screwdriver

TDW-767S3
Industrial 3/8" impact wrench



TDW-777
Industrial 1/4" screwdriver



TDW-757
Industrial 1/4" screwdriver



TDW-757S3
Industrial 3/8" impact wrench

Model	SQ Drive	Free Speed	Max Torque		Net Weight		Overall Length		Noise Level	Average Air Cons. @ Load		Air Inlet NPTF	Hose Size	
	inch	rpm	ft-lb	Nm	lb	kg	inch	mm	dBA	cfm	L/min	inch	inch	mm
TDW-757	1/4 hex	8,000	65	88	2.2	1.0	7.9	201	87	2.8	80	1/4	1/4	6.4
TDW-757S3	3/8	8,000	65	88	2.2	1.0	7.6	193	87	2.8	80	1/4	1/4	6.4
TDW-767	1/4 hex	8,000	65	88	2.5	1.2	6.6	168	87	2.8	80	1/4	1/4	6.4
TDW-767S3	3/8"	8,000	65	88	2.5	1.1	6.3	159	87	2.8	80	1/4	1/4	6.4
TDW-777	1/4 hex	8,000	58	79	2.0	0.9	6.1	155	80	4.0	113	1/4	1/4	6.4

[TDW Series - Oil-Bathed Type]



TDW-278V

Industrial 3/4"
Impact Wrench,
Super Hammer
Composite Housing



TDW-243N

Industrial 1/2"
impact wrench,
Twin Hammer
Composite Housing



TDW-243C

Industrial 3/8"
impact wrench
Super Hammer
Composite Housing



TDW-243E

Industrial 1/2"
impact wrench,
Twin Hammer



TDW-307B

Industrial 1/2"
impact wrench
Super Hammer
Composite Housing

Model	SQ Drive	Free Speed	Max Torque Reverse		Net Weight		Overall Length		Noise Level	Average Air Cons. @ Load		Air Inlet NPTF	Hose Size		
	inch	rpm	ft-lb	Nm	lb	kg	inch	mm	dBA	cfm	L/min	inch	inch	mm	
TDW-243C	3/8	9,500	297	403	2.9	1.3	6.7	170	89	7.4	210	1/4	3/8	10	
TDW-243E	1/2	8,000	109	148	2.6	1.2	7.3	185	89	4.9	140	1/4	3/8	10	
TDW-243N	1/2	8,000	253	343	2.6	1.2	5.0	127	90	4.2	118	1/4	3/8	10	
TDW-307B	1/2	7,000	796	1,080	4.6	2.1	7.8	198	90	5.7	161	1/4	3/8	10	
TDW-278V	3/4	4,000	1,396	1,894	8.4	3.8	9.6	244	90	7.8	221	3/8	1/2	13	
TDW-315S-L	1	5,000	1,447	1,964	18.5	8.4	20.7	525	106	10.6	300	1/2	1/2	13	

TDW-315S-L

Industrial 1"
impact wrench





- Aluminum Ratchets
- Composite Ratchets

Air Ratchet Wrenches

[Aluminum Ratchets]



TPT-221
1/4" Ratchet Wrench

TPT-221-3
with 3/8" square drive



TPT-222
1/4" Ratchet Wrench

TPT-222-3
with 3/8" square drive



TPT-217
3/8" Ratchet Wrench

TPT-217-4
with 1/2" square drive



TPT-225
3/8" Heavy Duty Ratchet Wrench

TPT-225-4
with 1/2" square drive



TPT-226
3/8" Heavy Duty Ratchet Wrench

TPT-226-4
with 1/2" square drive



TPT-219
1/2" Heavy Duty Ratchet Wrench



TPT-220-3
3/8" Mini Ratchet Wrench
(2 in 1)



TPT-220-3R
3/8" Mini Ratchet Wrench
with revolving head

Model	SQ Drive	Free Speed	Max Torque Reverse		Net Weight		Overall Length		Noise Level	Average Air Cons. @ Load		Air Inlet NPTF	Hose Size	
	inch	rpm	ft-lb	Nm	lb	kg	inch	mm	dBA	cfm	L/min	inch	inch	mm
TPT-221	1/4	220	26	35	1.3	0.6	6.9	174	83	3.9	110	1/4	3/8	10
TPT-221-3	3/8	220	26	35	1.3	0.6	6.9	174	83	3.9	110	1/4	3/8	10
TPT-222	1/4	260	15	20	1.1	0.5	5.1	130	86	3.9	110	1/4	3/8	10
TPT-222-3	3/8	260	15	20	1.1	0.5	5.1	130	86	3.9	110	1/4	3/8	10
TPT-217	3/8	160	55	75	2.6	1.2	10.0	254	93	8.5	240	1/4	3/8	10
TPT-217-4	1/2	160	55	75	2.6	1.2	10.0	254	93	8.5	240	1/4	3/8	10
TPT-225	3/8	160	60	81	2.6	1.2	10.2	260	93	9.5	269	1/4	3/8	10
TPT-225-4	1/2	160	60	81	2.6	1.2	10.2	260	93	9.5	269	1/4	3/8	10
TPT-226	3/8	160	55	75	2.4	1.1	10.6	270	93	9.0	255	1/4	3/8	10
TPT-226-4	1/2	160	55	75	2.4	1.1	10.6	270	93	9.0	255	1/4	3/8	10
TPT-219	1/2	150	90	122	4.4	2.0	14.2	360	103	8.0	225	1/4	3/8	10
TPT-220-3	3/8	260	20	27	0.9	0.4	4.7	120	87	10.6	300	1/4	3/8	10
TPT-220-3R	3/8	260	20	27	0.9	0.4	4.7	120	87	10.6	300	1/4	3/8	10



TPT-223
Inline Ratchet Wrench



TPT-224
Inline Ratchet Wrench

Model	Bolt Capacity	Free Speed	Max Torque		Net Weight		Overall Length		Noise Level	Average Air Cons. @ Load		Air Inlet NPTF	Hose Size	
	mm	rpm	ft-lb	Nm	lb	kg	inch	mm	dBA	cfm	L/min	inch	inch	mm
TPT-223	M6-M12	180	7	10	2.9	1.3	11.8	300	86	4.5	127	1/4	1/4	6.4
TPT-224	M10-M14	250	18	25	3.9	1.8	13.4	340	87	7.5	212	1/4	1/4	6.4

[Composite Ratchets]



TPT-221F
1/4" Ratchet Wrench
TPT-221F-3
with 3/8" square drive

Accessories for Air Ratchets

216-039 Head Cover
Apply to: TPT-217, TPT-217F

222F-046 Head Cover
Apply to: TPT-221, TPT-221F



TPT-217F
3/8" Ratchet Wrench
TPT-217F-4
with 1/2" square drive



Model	SQ Drive	Free Speed	Max Torque		Net Weight		Overall Length		Noise Level	Average Air Cons. @ Load		Air Inlet NPTF	Hose Size	
	inch	rpm	ft-lb	Nm	lb	kg	inch	mm	dBA	cfm	L/min	inch	inch	mm
TPT-221F	1/4	230	26	35	1.3	0.6	7.6	194	83	1.9	55	1/4	3/8	10
TPT-221F-3	3/8	230	26	35	1.3	0.6	7.6	194	83	1.9	55	1/4	3/8	10
TPT-217F	3/8	160	60	81	2.0	0.9	10.6	270	86	6.0	170	1/4	3/8	10
TPT-217-4	1/2	160	60	81	2.0	0.9	10.6	270	86	6.0	170	1/4	3/8	10

Head Cover not included

[Sockets]



01-0231

1/2"

Deep Socket Set (4 pcs)
17mm / 19mm / 21mm / 22mm / 80mmL
Color Socket also available



01-0226

1/2"

Socket Set (3 pcs)
17mm / 19mm / 21mm / 39mmL
Color Socket also available



01-0233

1/2"

Thin Wall Wheel Socket Set (3pcs)
17mm / 19mm / 21mm / 85mmL



01-0234

1/2"

Deep Socket Set (3pcs)
17mm / 19mm / 21mm / 78mmL



01-0235

1/2"

Thin Wall Wheel Socket kit
17mm / 19mm / 21mm



01-0236

1/2"

Thin Wall Wheel Socket kit
15mm / 17mm / 19mm / 21mm



01-0263

3/4"

Socket Set (4 pcs)
17mm / 19mm / 21mm / 27mm



01-0281

1"

Socket Set (4 pcs)
21mm / 27mm / 38mm / 41mm



Air Grinders and Cutting Tools

■ Angle Grinders ■ Die Grinders ■ Composite Grinders ■ Cutting Tools

[Corner Grinder]



TPT-622FB

Wheel Size: 100 x 10

Model	Spindle Thread	Free Speed	Rated Power		Net Weight		Overall Length		Noise Level	Average Air Cons. @ Load		Air Inlet NPTF	Hose Size	
	in	rpm	hp	KW	lb	kg	inch	mm	dBA	cfm	L/min	inch	inch	mm
TPT-622FB	3/8	14,000	0.5	0.4	2.9	1.3	14.6	372	86	9.5	268	1/4	3/8	10

[Angle Grinders]



TPT-507

4" Angle Grinder, M10 x 1.5

TPT-507-B

with 5" wheel, M14 x 2



TPT-507H

4" Industrial Angle Grinder, 3/8" -24

TPT-507H-B

with 5" wheel, M14 x 2

Model	Spindle Thread	Free Speed	Rated Power		Net Weight		Overall Length		Noise Level	Average Air Cons. @ Load		Air Inlet NPTF	Hose Size	
	in	rpm	hp	KW	lb	kg	inch	mm	dBA	cfm	L/min	inch	inch	mm
TPT-507	M10 x 1.5P	11,000	1.0	0.7	3.9	1.8	8.9	226	86	17.3	490	1/4	3/8	10
TPT-507-B	M14 x 2P	11,000	1.0	0.7	3.9	1.8	8.9	226	86	17.3	490	1/4	3/8	10
TPT-507H	3/8 - 24	11,000	1.0	0.7	4.4	2.0	9.7	246	86	13.4	380	1/4	3/8	10
TPT-507H-B	M14 x 2P	11,000	1.0	0.7	4.4	2.0	9.7	246	86	13.4	380	1/4	3/8	10

Grinding Disc not included; Spindle Size available : 8/5"-11"; M10 x 1.5P; M14 x 1.5P; M14 x 2P
All with safty trigger



TPT-507R
4" Angle Grinder, M10 x 1.5,
Roller Switch
TPT-507R-B
with 5" disc, M14 x 2



TPT-508
7" Angle Grinder



TPT-508H
7" Industrial Angle Grinder



TPT-509
4" Angle 100° Grinder, 3/8" -24
TPT-509-B
with 5" disc, M14 x 2



TPT-910
7" Vertical Grinder



TPT-911
9" Vertical Grinder

Model	Spindle Thread	Free Speed	Rated Power		Net Weight		Overall Length		Noise Level	Average Air Cons. @ Load		Air Inlet NPTF	Hose Size	
	in	rpm	hp	KW	lb	kg	inch	mm	dBA	cfm	L/min	inch	inch	mm
TPT-507R	M10 x 1.5P	11,000	1.0	0.7	3.3	1.5	8.9	226	86	17.3	490	1/4	3/8	10
TPT-507R-B	M14 x 2P	11,000	1.0	0.7	3.3	1.5	8.9	226	86	17.3	490	1/4	3/8	10
TPT-508	5/8 - 11	7,000	1.2	0.9	7.0	3.2	13.5	343	101	9.0	255	1/4	3/8	10
TPT-508H	5/8 - 11	7,600	1.2	0.9	6.6	3.0	11.8	300	101	9.0	255	1/4	3/8	10
TPT-509	3/8 - 24	10,000	1.2	0.9	3.1	1.4	9.6	244	86	5.0	142	1/4	3/8	10
TPT-509-B	M14 x 2P	10,000	1.2	0.9	3.1	1.4	9.6	244	85	5.0	142	1/4	3/8	10
TPT-910	5/8 - 11	7,000	1.5	1.1	9.2	4.2	13.4	340	84	16.3	461	1/4	3/8	10
TPT-911	5/8 - 11	6,000	1.5	1.1	9.7	4.4	13.4	340	83	16.3	461	1/4	3/8	10

Grinding Disc not included; Spindle Size available: 8/5"-11"; M10 x 1.5P; M14 x 1.5P; M14 x 2P
All with safty trigger, except TPT-507R-B.

[Die Grinders]



TPT-501A
1/4" Mini Angle Die Grinder



TPT-501
1/4" Mini Die Grinder

TPT-521
1/4" Die Grinder



TPT-522
1/4" Die Grinder



Model	Collect Size	Free Speed	Rated Power		Net Weight		Overall Length		Noise Level	Average Air Cons. @ Load		Air Inlet NPTF	Hose Size		
	inch	rpm	hp	kw	lb	kg	inch	mm	dBA	cfm	L/min	inch	inch	mm	
TPT-501	1/4(6)	25,000	0.3	0.2	0.9	0.4	5.6	142	86	9.5	270	1/4	3/8	10	
TPT-501A	1/4(6)	22,000	0.3	0.2	1.1	0.5	5.6	142	86	9.5	270	1/4	3/8	10	
TPT-521	1/4(6)	20,000	0.5	0.4	1.5	0.7	7.0	177	86	9.9	280	1/4	3/8	10	
TPT-522	1/4(6)	3,500	0.5	0.4	2.0	0.9	8.6	218	86	9.9	280	1/4	3/8	10	

TPT-523

Stripping Tool



TPT-524

1/4" Die Grinder Extended



TPT-531-B

Heavy Duty Die Grinder



TPT-532-B

Low Speed Die Grinder



Model	Collect Size	Free Speed	Rated Power		Net Weight		Overall Length		Noise Level	Average Air Cons. @ Load		Air Inlet NPTF	Hose Size		
	inch	rpm	hp	kw	lb	kg	inch	mm	dBA	cfm	L/min	inch	inch	mm	
TPT-523	N/A	2,000	0.5	0.4	2.0	0.9	8.6	218	85	9.9	280	1/4	3/8	10	
TPT-524	1/4(6)	20,000	0.5	0.4	2.2	1.0	12.6	319	86	9.9	280	1/4	3/8	10	
TPT-531-B	0.3(8)	13,500	0.9	0.7	4.0	1.8	14.8	377	83	11.3	320	1/4	3/8	10	
TPT-532-B	0.3(8)	4,000	0.9	0.7	4.0	1.8	14.8	377	83	11.3	320	1/4	3/8	10	

TPT-502H
1/8" Micro Die Grinder



TPT-503H
1/8" Micro Die Grinder



TPT-504H
1/8" Micro Die Grinder



TPT-505H
1/8" Angle Surface Grinder



Model	Collect Size	Free Speed	Rated Power		Net Weight		Overall Length		Noise Level	Average Air Cons. @ Load		Air Inlet NPTF	Hose Size	
	inch	rpm	hp	kw	lb	kg	inch	mm	dBA	cfm	L/min	inch	inch	mm
TPT-502H	1/8(3)	60,000	0.2	0.1	0.4	0.2	5.3	135	82	4.9	140	1/4	1/4	6.4
TPT-503H	1/8(3)	65,000	0.2	0.1	0.2	0.1	6.5	165	84	4.2	120	1/4	1/4	6.4
TPT-504H	1/8(3)	80,000	0.2	0.1	0.7	0.3	6.3	160	84	5.7	160	1/4	1/4	6.4
TPT-505H	1/8(3)	23,500	0.2	0.1	0.4	0.2	5.5	140	84	4.2	120	1/4	1/4	6.4

Sanding Disc Not Included

TPT-506

Turbo Lab Grinder(Liner)

TPT-506-03

with stroke 0.3mm

TPT-506-07

with stroke 0.7mm

TPT-506-12

with stroke 1.2mm

**TPT-506S**

Turbo Lab Grinder(Swing)

TPT-506S-03

with stroke 0.3mm

TPT-506S-07

with stroke 0.7mm

TPT-506S-12

with stroke 1.2mm

Model	Collect Size	Rated Power		Net Weight		Overall Length		Noise Level	Average Air Cons. @ Load		Air Inlet NPTF		Hose Size	
	inch	hp	kw	lb	kg	inch	mm	dBA	cfm	L/min	inch	inch	mm	mm
TPT-506,506S	-	-	-	0.4	0.2	7.3	185	84	4.2	120	1/4	1/4	6.4	
Free Speed	TPT-506-03		TPT-506-07		TPT-506-12		TPT-506S-03		TPT-506S-07		TPT-506S-12			
rpm	60,000		30,000		20,000		55,000		20,000		10,000			

TPT-525

High Speed Tire Buffer

**TPT-526**

Low Speed Tire Buffer

**TPT-532**

Low Speed Tire Buffer



Model	Spindle Thread	Free Speed	Rated Power		Net Weight		Overall Length		Noise Level	Average Air Cons. @ Load		Air Inlet NPTF		Hose Size	
	inch	rpm	hp	kw	lb	kg	inch	mm	dBA	cfm	L/min	inch	inch	mm	mm
TPT-525	3/8-24	20,000	0.5	0.4	2.0	0.9	9.2	234	86	9.9	280	1/4	3/8	10	
TPT-526	3/8-24	3,500	0.5	0.4	2.2	1.0	9.6	243	86	9.9	280	1/4	3/8	10	
TPT-532	5/8-18	4,000	0.9	0.7	3.7	1.7	14.4	365	83	11.3	320	1/4	3/8	10	



TPT-530
Heavy Duty Wheel Grinder



TPT-531-C
Heavy Duty Wheel Grinder



TPT-533
6" Super Duty Wheel Grinder



531-045, 533-045



513-001

Accessories for Die Grinders		
Part No.		Apply to
531-045	2.5" Sanding Disc	TPT-531C
533-045	6" Sanding Disc	TPT-533
513-001	Eraser Wheel	TPT-523, TPT-523F

Model	Wheel / Disc	Free Speed	Rated Power		Net Weight		Overall Length		Noise Level	Average Air Cons. @ Load		Air Inlet NPTF	Hose Size		
	inch	rpm	hp	kw	lb	kg	inch	mm	dBA	cfm	L/min	inch	inch	mm	
TPT-530	3	20,000	0.5	0.4	2.2	1	7.9	200	86	15.2	430	1/4	3/8	10	
TPT-531-C	3	13,500	0.9	0.7	3.7	1.7	13.3	338	83	11.3	320	1/4	3/8	10	
TPT-533	6	5,700	0.9	0.7	11.4	5.2	19.7	500	87	26.9	760	1/4	3/8	10	

[Composite Die Grinders]



TPT-521F
1/4" Die Grinder



TPT-522F
1/4" Die Grinder



TPT-523F
Stripping Tool



TPT-524F
1/4" Die Grinder Extended

TPT-542A
1/4" Angle 97° Die Grinder

Model	Collect Size	Free Speed	Rated Power		Net Weight		Overall Length		Noise Level	Average Air Cons. @ Load		Air Inlet NPTF	Hose Size	
	in(mm)	rpm	hp	KW	lb	kg	inch	mm	dBA	cfm	L/min	inch	inch	mm
TPT-521F	1/4(6)	20,000	0.5	0.4	1.3	0.6	7.1	180	85	9.9	280	1/4	3/8	10
TPT-522F	1/4(6)	3,500	0.5	0.4	2.0	0.9	8.8	223	85	9.9	280	1/4	3/8	10
TPT-523F	-	2,000	0.5	0.4	2.0	0.9	8.5	217	85	9.9	280	1/4	3/8	10
TPT-524F	1/4(6)	20,000	0.5	0.4	2.2	1.0	12.6	319	86	9.9	280	1/4	3/8	10
TPT-542A	1/4(6)	22,000	0.4	0.3	1.1	0.5	6.7	170	80	9.5	270	1/4	3/8	10

[Composite Die Grinders]



TPT-535B
1/4" Die Grinder



TPT-536B
1/4" Die Grinder

Model	Collect Size	Free Speed	Rated Power		Net Weight		Overall Length		Noise Level	Average Air Cons. @ Load		Air Inlet NPTF	Hose Size	
	in(mm)	rpm	hp	KW	lb	kg	inch	mm	dBA	cfm	L/min	inch	inch	mm
TPT-535B	1/4(6)	25,000	0.3	0.2	0.9	0.4	6.0	153	86	10.6	300	1/4	3/8	10
TPT-536B	1/4(6)	25,000	0.3	0.2	1.1	0.5	7.8	199	86	10.6	300	1/4	3/8	10
TPT-537B	1/4(6)	20,000	0.3	0.2	1.1	0.5	6.0	153	86	10.6	300	1/4	3/8	10
TPT-538B	1/4(6)	15,000	0.3	0.2	1.1	0.5	6.7	169	86	10.6	300	1/4	3/8	10



TPT-537B
1/4" Angle Die Grinder



TPT-538B
1/4" Angle Die Grinder



TPT-501F
1/4" Mini Die Grinder



TPT-501FA
1/4" Mini Angle Die Grinder



TPT-525F
High Speed Tire Buffer



TPT-526F
Low Speed Tire Buffer



TPT-530FB
Air Cut-off Tool

Model	Collect Size	Free Speed	Rated Power		Net Weight		Overall Length		Noise Level	Average Air Cons. @ Load		Air Inlet NPTF	Hose Size	
	in(mm)	rpm	hp	KW	lb	kg	inch	mm	dBA	cfm	L/min	inch	inch	mm
TPT-501F	1/4(6)	25,000	0.3	0.2	0.9	0.4	5.6	142	86	9.5	270	1/4	3/8	10
TPT-501FA	1/4(6)	22,000	0.3	0.2	1.1	0.5	5.6	142	86	9.5	270	1/4	3/8	10
Model	Thread	Speed	Power		Weight		Length		Level	Cons. @ Load		NPTF	Size	
	in	rpm	hp	KW	lb	kg	inch	mm	dBA	cfm	L/min	inch	inch	mm
TPT-525F	3/8-24	20,000	0.5	0.4	2.0	0.9	9.2	234	86	9.9	280	1/4	3/8	10
TPT-526F	3/8-24	3,500	0.5	0.4	2.2	1.0	9.6	243	86	9.9	280	1/4	3/8	10
Model	Disk Size	Free Speed	Rated Power		Net Weight		Overall Length		Noise Level	Average Air Cons. @ Load		Air Inlet NPTF	Hose Size	
	in	rpm	hp	KW	lb	kg	inch	mm	dBA	cfm	L/min	inch	inch	mm
TPT-530FB	3	20,000	0.5	0.4	2.2	1	7.5	190	85	15.2	430	1/4	3/8	10

[Cutting Tools]



TPT-472
Air File



TPT-473
Air File



TPT-529F
Composite Air Shear

Model	Stroke Speed	Piston Stroke	Net Weight		Overall Length		Noise Level	Average Air Cons. @ Load		Air Inlet NPTF	Hose Size	
	bpm	mm	lb	kg	inch	mm	dBA	cfm	L/min	inch	inch	mm
TPT-472	3,700	10	2.2	1.0	6.5	165	90	4.2	120	1/4	3/8	10
TPT-473	3,400	5	1.1	0.5	6.9	174	86	7.1	200	1/4	3/8	10

Model	Cutting Capacity	Cutting Width	Net Weight		Overall Length		Noise Level	Average Air Cons. @ Load		Air Inlet NPTF	Hose Size	
	mm	mm	lb	kg	inch	mm	dBA	cfm	L/min	inch	inch	mm
TPT-529F	1.5	5	2.4	1.1	8.0	204	85	19.1	540	1/4	3/8	10

TPT-640C-K
TPT-640-K
Air Body Saw Kit



TPT-640
Air Body Saw



TPT-640C
Air Body Saw(Rear Exhaust)



TPT-690
Air Nibbler



Model	Stroke Speed	Piston Stroke	Net Weight		Overall Length		Noise Level	Average Air Cons. @ Load		Air Inlet NPTF	Hose Size	
	bpm	mm	lb	kg	inch	mm	dBA	cfm	L/min	inch	inch	mm
TPT-640	9,500	10	1.5	0.7	11.0	280	83	7.8	220	1/4	3/8	10
TPT-640C	9,500	10	1.5	0.7	11.8	300	83	7.8	220	1/4	3/8	10
TPT-690	3,500	-	1.8	0.8	7.7	195	90	12.7	360	1/4	3/8	10



■ Sanders

Air Finishing Tools

[Random Orbital Sanders]



TPT-435

3" Random Orbital Sanders

Model	Pad Diameter	Orbital Diameter	Free Speed	Net Weight		Noise Level	Average Air Cons. @ Load		Air Inlet NPTF	Hose Size		Vac Type
	in(mm)	in(mm)	rpm	lb	kg	dBA	cfm	L/min	inch	inch	mm	
TPT-435N-3H	3	3/32(2.5)	10,000	1.5	0.7	83	19.1	540	1/4	3/8	10	NV
TPT-435C-3H	3	3/32(2.5)	10,000	1.5	0.7	83	19.1	540	1/4	3/8	10	CV



TPT-441



TPT-434



TPT-436

5" Random Orbital Sanders

Model	Pad Diameter	Orbital Diameter	Free Speed	Net Weight		Noise Level	Average Air Cons. @ Load		Air Inlet NPTF	Hose Size		Vac Type
	in(mm)	in(mm)	rpm	lb	kg	dBA	cfm	L/min	inch	inch	mm	
TPT-441N-5H	5	3/16(5)	12,000	1.8	0.8	82.0	15.5	439	1/4	3/8	10	NV
TPT-441S-5H	5	3/16(5)	12,000	1.8	0.8	82.0	15.5	439	1/4	3/8	10	SV
TPT-441C-5H	5	3/16(5)	12,000	1.8	0.8	82.0	15.5	439	1/4	3/8	10	CV
TPT-434N-5H	5	3/16(5)	12,000	1.5	0.7	82.0	15.5	439	1/4	3/8	10	NV
TPT-434S-5H	5	3/16(5)	12,000	1.5	0.7	82.0	15.5	439	1/4	3/8	10	SV
TPT-434C-5H	5	3/16(5)	12,000	1.5	0.7	82.0	15.5	439	1/4	3/8	10	CV
TPT-436N-5H	5	3/16(5)	10,000	1.5	0.7	82.0	15.5	439	1/4	3/8	10	NV
TPT-436S-5H	5	3/16(5)	10,000	1.5	0.7	82.0	15.5	439	1/4	3/8	10	SV
TPT-436C-5H	5	3/16(5)	10,000	1.5	0.7	82.0	15.5	439	1/4	3/8	10	CV

NV=Non-Vacuum;SV=Self Vacuum;CV=Central Vacuum

**TPT-441****TPT-437****TPT-434****6" Random Orbital Sanders**

Model	Pad Diameter	Orbital Diameter	Free Speed	Net Weight		Noise Level	Average Air Cons. @ Load		Air Inlet NPTF	Hose Size		Vac Type
	in(mm)	in(mm)	rpm	lb	kg	dBA	cfm	L/min	inch	inch	mm	
TPT-441N-6H	6	3/16(5)	12,000	1.8	0.8	82	15.5	439	1/4	3/8	10	NV
TPT-441S-6H	6	3/16(5)	12,000	1.8	0.8	82	15.5	439	1/4	3/8	10	SV
TPT-441C-6H	6	3/16(5)	12,000	1.8	0.8	82	15.5	439	1/4	3/8	10	CV
TPT-434N-6H	6	3/16(5)	12,000	1.5	0.7	82	15.5	439	1/4	3/8	10	NV
TPT-434S-6H	6	3/16(5)	12,000	1.5	0.7	82	15.5	439	1/4	3/8	10	SV
TPT-434C-6H	6	3/16(5)	12,000	1.5	0.7	82	15.5	439	1/4	3/8	10	CV
TPT-437N-6H	6	3/16(5)	10,000	1.5	0.7	82	15.5	439	1/4	3/8	10	NV
TPT-437S-6H	6	3/16(5)	10,000	1.5	0.7	82	15.5	439	1/4	3/8	10	SV
TPT-437C-6H	6	3/16(5)	10,000	1.5	0.7	82	15.5	439	1/4	3/8	10	CV

NV=Non-Vacuum;SV=Self Vacuum;CV=Central Vacuum

[Random Orbital Sanders]



6" Random Orbital Sanders

Model	Pad Diameter	Orbital Diameter	Free Speed	Net Weight		Noise Level	Average Air Cons. @ Load		Air Inlet NPTF	Hose Size		Vac Type
	in(mm)	in(mm)	rpm	lb	kg	dBA	cfm	L/min	inch	inch	mm	
TPT-446N-6H	6	3/16(5)	9,000	3	1.5	88	15.7	445	1/4	3/8	10	NV
TPT-446S-6H	6	3/16(5)	9,000	3	1.5	88	15.7	445	1/4	3/8	10	SV
TPT-446C-6H	6	3/16(5)	9,000	3	1.5	88	15.7	445	1/4	3/8	10	CV
TPT-447N-6H	6	3/8(10)	9,000	3	1.5	88	15.7	445	1/4	3/8	10	NV
TPT-447S-6H	6	3/8(10)	9,000	3	1.5	88	15.7	445	1/4	3/8	10	SV
TPT-447C-6H	6	3/8(10)	9,000	3	1.5	88	15.7	445	1/4	3/8	10	CV

NV=Non-Vacuum;SV=Self Vacuum;CV=Central Vacuum

[Palm Sanders]

TPT-420

Palm Sander



TPT-430

Palm Sander



Model	Pad Size	Orbital Diameter	Free Speed	Net Weight		Noise Level	Average Air Cons. @ Load		Air Inlet NPTF	Hose Size			Air Inlet NPTF
	mm	in(mm)	rpm	lb	kg	dBA	cfm	L/min	inch	inch	mm		
TPT-420	75 x 82	1.2	15,000	1.1	0.5	77	0.8	22.6	1/4	3/8	10		NV
TPT-430	100 x 110	1.6	20,000	1.1	0.5	84	1.0	28.3	1/4	3/8	10		NV

[Jitterbug Sanders]

TPT-431

Jitterbug Sander



TPT-432

Tri-Form Sander]
(Non-Vac)



TPT-442

Jitterbug Sander



TPT-445

2-Hand Jitterbug Sander



Model	Pad Size	Orbital Diameter	Free Speed	Net Weight		Noise Level	Average Air Cons. @ Load		Air Inlet NPTF	Hose Size			Vac Type
	mm	mm	rpm	lb	kg	dBA	cfm	L/min	inch	inch	mm		
TPT-431	100 x 10	2.5	11,000	2.0	0.9	82	9	255	1/4	3/8	10		NV
TPT-432	125 x 95	5	11,000	1.8	0.8	82	9	255	1/4	3/8	10		NV
TPT-442	100 x 180	3.2	8,500	2.6	1.2	80	9	255	1/4	3/8	10		NV
TPT-445	100 x 180	5	7,500	3.3	1.5	88	9	255	1/4	3/8	10		NV

NV=Non-Vacuum;SV=Self Vacuum;CV=Central Vacuum

[Mini Sanders/polishers]



TPT-411

2" Mini Orbital Sander



TPT-413

3" Mini Polisher



TPT-414

3" Mini Grinder



TPT-415

3" Mini Orbital Sander



TPT-416

3" Mini Polisher



TPT-417

Finger Sander

*Pad Thread 5/16"-24

Model	Pad/ Disc Size	Orbital Diameter	Free Speed	Net Weight		Overall Length		Noise Level	Average Air Cons. @ Load		Air Inlet NPTF	Hose Size	
	inch	mm	rpm	lb	kg	inch	mm	dBA	cfm	L/min	inch	inch	mm
TPT-411	2	3	15,000	1.5	0.7	6.3	160	82	10.5	297	1/4	3/8	10
TPT-413	3	1.5	15,000	1.5	0.7	6.3	160	82	10.5	297	1/4	3/8	10
TPT-414	3	3	15,000	1.5	0.7	6.3	160	82	10.5	297	1/4	3/8	10
TPT-415	3	2	16,500	2.2	1.0	6.3	160	82	5.0	142	1/4	3/8	10
TPT-416	3	0.75	15,000	1.8	0.8	6.3	160	80	10.5	297	1/4	3/8	10
TPT-417	-	3	13,000	1.8	0.8	7.9	200	82	10.5	297	1/4	3/8	10

[Vertical Sanders/Polishers]



TPT-480
7" Heavy Duty Angle
Sander



TPT-481
7" Heavy Duty Vertical
sander



TPT-490
7" Heavy Duty Angle
Polisher



TPT-491
7" Heavy Duty Vertical
Polisher

Model	Pad/ Disc Size	Free Speed	Spindle Thread	Net Weight		Overall Length		Noise Level	Average Air Cons. @ Load		Air Inlet NPTF	Hose Size	
	inch	rpm	inch	lb	kg	inch	mm	dBA	cfm	L/min	inch	inch	mm
TPT-480	7	4,500	5/8 - 11	6.4	2.9	17.4	441	81	19	524	1/4	3/8	10
TPT-481	7	4,500	5/8 - 11	5.7	2.6	7.5	190	88	16	453	1/4	3/8	10
TPT-490	7	2,500	5/8 - 11	6.4	2.9	17.4	441	81	19	524	1/4	3/8	10
TPT-491	7	2,000	5/8 - 11	5.7	2.6	17.7	450	88	16	453	1/4	3/8	10

[Belt Sanders]

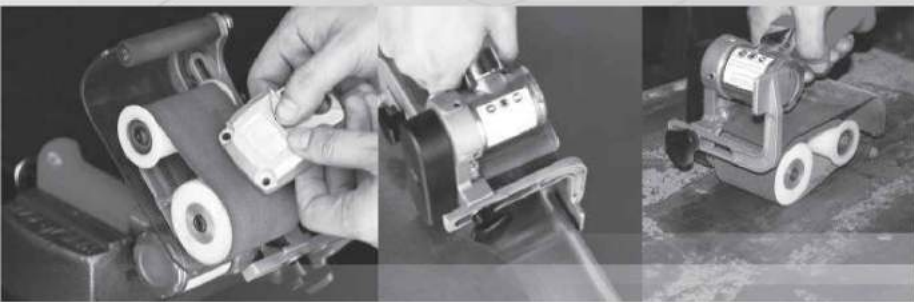

TPT-469
60mm Belt Sander



TPT-475
10mm Belt Sander



TPT-448
Straight Line Sander



TPT-476
20mm Belt Sander



TPT-474
30mm Belt Sander

Model	Belt Size	Free Speed	Net Weight		Overall Length		Noise Level	Average Air Cons. @ Load		Air Inlet NPTF	Hose Size	
	mm	rpm	lb	kg	inch	mm	dBA	cfm	L/min	inch	inch	mm
TPT-475	10 x 330	18,000	2.0	0.9	6.5	165	88	4	113	1/4	3/8	10
TPT-476	20 x 520	17,000	2.9	1.3	6.9	174	86	3	85	1/4	3/8	10
TPT-474	30 x 540	13,000	4.6	2.1	11.0	280	92	3	85	1/4	3/8	10
TPT-469	60 x 260	4,500	2.4	1.1	11.8	300	82	5	150	1/4	3/8	10
TPT-448	400 x 70	2,300	6.6	3.0	7.7	195	80	11	303	1/4	3/8	10



Air Drills and Screwdrivers

■ Air Drills ■ Air Screwdrivers

[Air Drills]



TPT-610R
1/2" Reversible Drill



TPT-600R
3/8" Reversible Drill



TPT-601R
3/8" Reversible Drill



TPT-602R
1/2" Reversible Drill



TPT-605
3/8" Non-Reversible Drill
with key chuck

TPT-605-4
With 1/2" key chuck

Model	Chuck Size	Free Speed	Rated Power		Net Weight		Overall Length		Noise Level	Average Air Cons. @ Load		Air Inlet NPTF	Hose Size	
	in	rpm	hp	KW	lb	kg	inch	mm	dBA	cfm	L/min	inch	inch	mm
TPT-600R	3/8	1,800	0.5	0.4	2.9	1.3	7.0	177	87	8.5	240	1/4	3/8	10
TPT-610R	1/2	750	0.5	0.4	4.0	1.8	8.0	203	87	8.5	240	1/4	3/8	10
TPT-601R	3/8	2,300	0.5	0.4	2.9	1.3	7.5	191	83	10.0	283	1/4	3/8	10
TPT-602R	1/2	500	0.5	0.4	4.0	1.8	9.0	228	83	10.0	283	1/4	3/8	10
TPT-605	3/8	2,200	0.5	0.4	2.2	1.0	7.0	177	87	10.0	283	1/4	3/8	10
TPT-605-4	1/2	2,200	0.5	0.4	2.2	1.0	7.0	177	87	10.0	283	1/4	3/8	10



TPT-606
1/2" Non-Reversible Drill



TPT-607
1/2" Non-Reversible Drill



TPT-608
3/8" Non-Reversible Drill

Model	Chuck Size	Free Speed	Rated Power		Net Weight		Overall Length		Noise Level	Average Air Cons. @ Load		Air Inlet NPTF	Hose Size	
	in	rpm	hp	KW	lb	kg	inch	mm	dBA	cfm	L/min	inch	inch	mm
TPT-606	1/2	800	0.5	0.4	4.0	1.8	8.0	203	87	8.5	241	1/4	3/8	10
TPT-607	1/2	500	0.5	0.4	4.0	1.8	9.0	228	87	8.5	241	1/4	3/8	10
TPT-608	3/8	1,500	0.5	0.4	2.4	1.1	7.8	197	75	3.0	85	1/4	3/8	10
TPT-621A	3/8	1,800	0.5	0.4	2.4	1.1	7.9	201	75	3.0	85	1/4	3/8	10
TPT-527	3/8	2,000	0.5	0.4	2.4	1.1	7.9	201	75	3.0	85	1/4	3/8	10

TPT-621A
3/8" Reversible Angle Drill



TPT-527
3/8" Air Straight Drill



[Air Drills with Composite Housing]



TPT-527F
3/8" Air Drill



TPT-621FB
3/8" Air Angle Drill

Model	Chuck Size	Free Speed	Rated Power		Net Weight		Overall Length		Noise Level	Average Air Cons. @ Load		Air Inlet NPTF	Hose Size	
	inch	rpm	hp	KW	lb	kg	inch	mm	dBA	cfm	L/min	inch	inch	mm
TPT-527F	3/8	2,000	0.5	0.4	2.2	1.0	8.6	218	85	9.9	280	1/4	3/8	10
TPT-621FB	3/8	2,000	0.5	0.4	2.2	1.0	8.8	224	85	9.9	280	1/4	3/8	10

[Accessories for Air Drills and Screwdrivers]



600R-032 Handle rubber
Apply to: TPT-600R, TPT-610R



766-027 Side handle
Apply to: TPT-726, TPT-728,
TPT-766, TPT-768

[Air Screwdrivers]

TPT-747

1/4" Screwdriver



TPT-769

1/4" Screwdriver



TPT-758

1/4" Screwdriver



TPT-722

1/4" Angle Screwdriver



Model	Bolt Capacity	Free Speed	Max Torque		Net Weight		Overall Length		Noise Level	Average Air Cons. @ Load		Air Inlet NPTF	Hose Size	
	mm	rpm	in-lbs	Nm	lb	kg	inch	mm	dBA	cfm	L/min	inch	inch	mm
TPT-747	M5	11,000	195	22	1.8	0.8	7.4	187	96	2.5	70	1/4	1/4	6.4
TPT-758	M6-M8	9,000	531	60	2.2	1.0	7.9	200	90	4.0	113	1/4	1/4	6.4
TPT-769	M6-M8	8,500	531	60	2.6	1.2	6.5	165	86	4.0	113	1/4	1/4	6.4
TPT-722	M4-M5	9,000	354	40	2.6	1.2	9.4	240	87	4.5	127	1/4	1/4	6.4

Model	Bolt Capacity	Free Speed	Max Torque		Net Weight		Overall Length		Noise Level	Average Air Cons. @ Load		Air Inlet NPTF	Hose Size	
	mm	rpm	in-lbs	Nm	lb	kg	inch	mm	dBA	cfm	L/min	inch	inch	mm
TPT-772	M6-M8	8,500	531	60	2.6	1.2	6.8	172	87	4.0	113	1/4	1/4	6.4
TPT-761	M6-M8	8,000	443	50	2.6	1.2	6.5	165	87	5.8	165	1/4	1/4	6.4
TPT-764	M6-M8	1,800	115	13	2.4	1.1	7.0	178	87	4.0	113	1/4	1/4	6.4
TPT-765	M6-M8	800	142	16	2.6	1.2	8.5	216	87	4.0	113	1/4	1/4	6.4



TPT-761
1/4" Screwdriver



TPT-772
1/4" Screwdriver



TPT-764
1/4" Torque Control
Screwdriver



TPT-765
1/4" Torque Control
Screwdriver



TPT-726
1/4" Torque Control Screwdriver



TPT-728
1/4" Torque Control Screwdriver

[Air Screwdrivers]



TPT-766
1/4" Torque Control Screwdriver



TPT-768
1/4" Torque Control Screwdriver

Model	Bolt Capacity	Free Speed	Max Torque		Net Weight		Overall Length		Noise Level	Average Air Cons. @ Load		Air Inlet NPTF	Hose Size	
	mm	rpm	in-lbs	Nm	lb	kg	inch	mm	dBA	cfm	L/min	inch	inch	mm
TPT-726	M3-M5	1,800	71	8	2.4	1.1	10.7	273	82	9.6	273	1/4	1/4	6.4
TPT-728	M3-M5	800	97	11	2.9	1.3	11.4	290	82	10.2	290	1/4	1/4	6.4
TPT-766	M3-M5	1,800	80	9	2.9	1.3	9.0	229	80	4.5	127	1/4	1/4	6.4
TPT-768	M3-M5	800	106	12	3.1	1.4	9.6	244	82	4.5	127	1/4	1/4	6.4

Industrial Air Screwdrivers



TDCS Series-Clutch Type

■ Pistol Type ■ Push Start ■ Lever Start ■ Angle Type

TORQUE RANGE REFERENCE

Torque is a very important reference value while choosing a right tool for tightening. Due to nut sizes, joint types, air pressure and working environment, the actual tightening torque may vary. The table below is only for a reference to choose the right tool. When the working torque is at the mean value of the torque range, the tool provides the best performance.

Tool Selection Chart

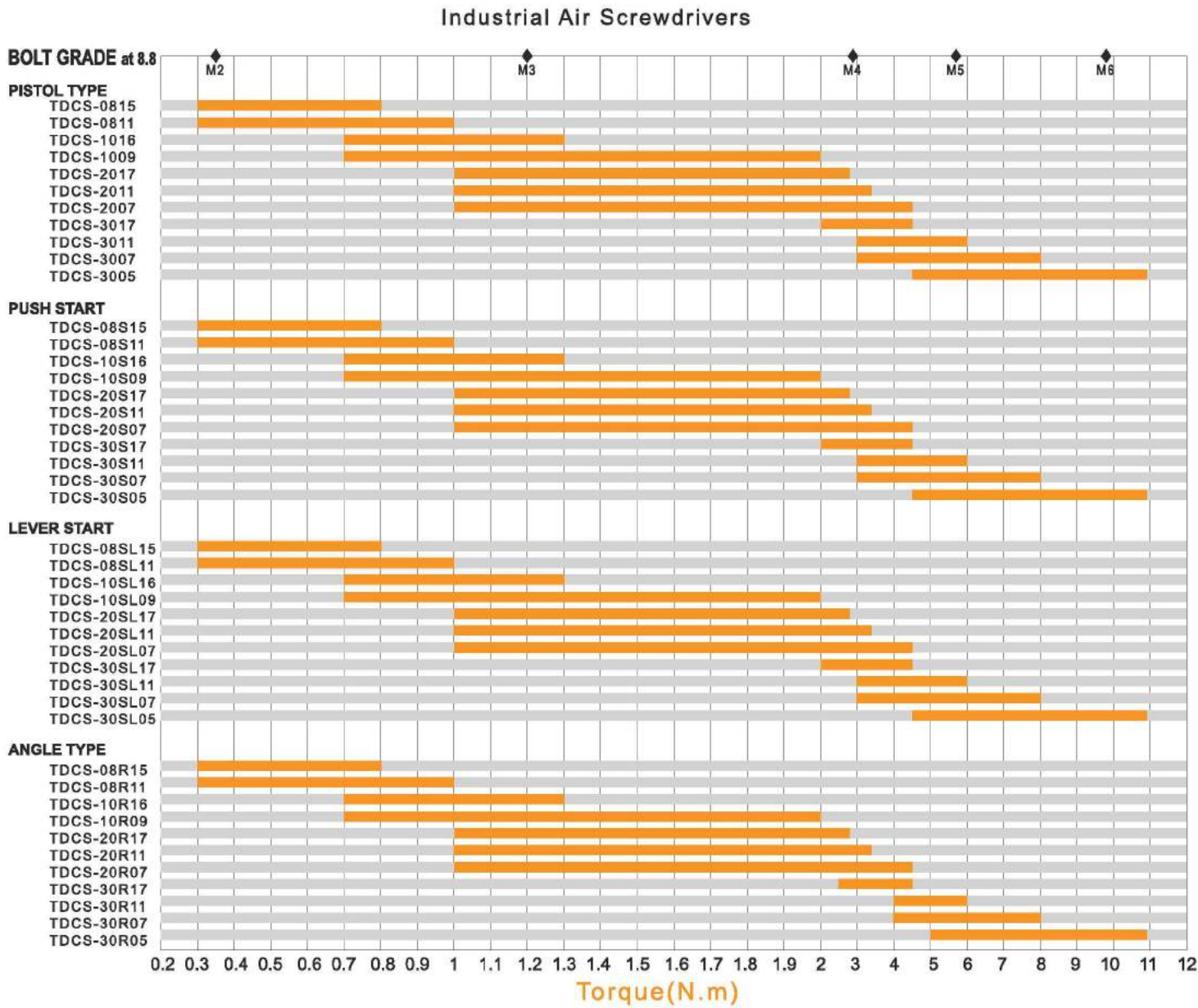



Highlights



Torque Conversion

Nm	kg-cm	in-lbs	Nm	kg-cm	in-lbs	Nm	kg-cm	in-lbs
0.1	1.02	0.89	1.3	13.26	11.51	7	71.38	61.95
0.2	2.04	1.77	1.4	14.28	12.39	8	81.58	70.81
0.3	3.06	2.66	1.5	15.30	13.28	9	91.77	79.66
0.4	4.08	3.54	1.6	16.32	14.16	10	101.97	88.51
0.5	5.10	4.43	1.7	17.34	15.05	11	112.17	97.36
0.6	6.12	5.31	1.8	18.35	15.93	12	122.37	106.21
0.7	7.14	6.20	1.9	19.37	16.82	13	132.56	115.06
0.8	8.16	7.08	2	20.39	17.70	14	142.76	123.91
0.9	9.18	7.97	3	30.59	26.55	15	152.96	132.76
1	10.20	8.85	4	40.79	35.40	16	163.16	141.61
1.1	11.22	9.74	5	50.99	44.25	17	173.35	150.46
1.2	12.24	10.6	6	61.18	53.10	18	183.55	159.31

[Pistol Type]



SPECIFICATIONS

Model	Screw Size	Torque Range		Bit Shank	Free Speed	Weight		Drive Size	Dia	Air Inlet	Average Air Consumption		Noise Level
	mm	in-lb	Nm	mm	rpm	kg	lb	inch	inch	inch	m³/min	ft³/min	dB(A)
TDCS-0815	M2	2.7 - 6.2	0.3 - 0.7	9	1,500	0.7	1.5	1/4 F/Hex	0.9	1/4	0.2	7	72
TDCS-0811	M2	3.5 - 8.8	0.4 - 1	9	1,100	0.7	1.5	1/4 F/Hex	0.9	1/4	0.2	7	72
TDCS-1016	M2-M3	6.2 - 12.3	0.7 - 1.3	9	1,600	0.9	1.98	1/4 F/Hex	1.1	1/4	0.35	12.5	75
TDCS-1009	M3	6.2 - 17.6	0.7 - 2	9	900	0.9	1.98	1/4 F/Hex	1.1	1/4	0.35	12.5	75
TDCS-2017	M3	8.8 - 26.4	1 - 3	9	1,700	1.15	2.53	1/4 F/Hex	1.37	1/4	0.47	16.5	78
TDCS-2011	M3-M4	8.8 - 30.8	1 - 3.5	9	1,100	1.15	2.53	1/4 F/Hex	1.37	1/4	0.47	16.5	78
TDCS-2007	M3-M4	8.8 - 35.2	1 - 4	9	700	1.15	2.53	1/4 F/Hex	1.37	1/4	0.47	16.5	78
TDCS-3017	M4	17.6 - 39.6	2 - 4.5	9	1,700	1.2	2.64	1/4 F/Hex	1.37	1/4	0.51	18	78
TDCS-3011	M4-M5	22 - 52.8	2.5 - 6	9	1,100	1.2	2.64	1/4 F/Hex	1.37	1/4	0.51	18	78
TDCS-3007	M5	26.4 - 70	3 - 8	9	700	1.2	2.64	1/4 F/Hex	1.37	1/4	0.51	18	78
TDCS-3005	M6	30.8 - 88	3.5 - 10	9	500	1.2	2.64	1/4 F/Hex	1.37	1/4	0.51	18	78

Recommended Air Pressure : TDCS-08.10 : 70psi (5kg/cm2)/0.5MPa TDCS-20.30 : 85psi (6kg/cm2)/0.6MPa
Air Hose Size : 10mm×6.5mm×5m

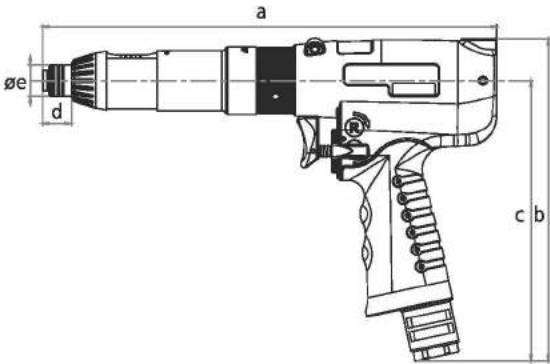

Dimensions

Model	a (mm)	b (mm)	c (mm)	d (mm)	e (mm)
TDCS-08	218	162.3	143.8	16	ø16
TDCS-10	211	162.3	143.8	16	ø16
TDCS-20	232	164.5	143.3	16	ø16
TDCS-30	234	164.5	143.3	16	ø16

SPECIFICATIONS

Model	Screw Size	Torque Range		Bit Shank	Free Speed	Weight		Drive Size	Dia	Air Inlet	Average Air Consumption		Noise Level
	mm	in-lb	Nm	mm	rpm	kg	lb	inch	inch	inch	m³/min	ft³/min	dB(A)
TDCS-08S15	M2	2.7 - 6.2	0.3 - 0.7	9	1,500	0.35	0.77	1/4 F/Hex	0.9	1/8	0.2	7	73
TDCS-08S11	M2	3.5 - 8.8	0.4 - 1	9	1,100	0.35	0.77	1/4 F/Hex	0.9	1/8	0.2	7	73
TDCS-10S16	M2-M3	6.2 - 12.3	0.7 - 1.3	9	1,600	0.6	1.32	1/4 F/Hex	1.1	1/8	0.35	12.5	75
TDCS-10S09	M3	6.2 - 17.6	0.7 - 2	9	900	0.6	1.32	1/4 F/Hex	1.1	1/8	0.35	12.5	75
TDCS-20S17	M3	8.8 - 26.4	1 - 3	9	1,700	0.9	1.98	1/4 F/Hex	1.37	1/4	0.47	16.5	78
TDCS-20S11	M3-M4	8.8 - 30.8	1 - 3.5	9	1,100	0.9	1.98	1/4 F/Hex	1.37	1/4	0.47	16.5	78
TDCS-20S07	M3-M4	8.8 - 35.2	1 - 4	9	700	0.9	1.98	1/4 F/Hex	1.37	1/4	0.47	16.5	78
TDCS-30S17	M4	17.6 - 39.6	2 - 4.5	9	1,700	0.97	2.13	1/4 F/Hex	1.37	1/4	0.51	18	78
TDCS-30S11	M4-M5	22 - 52.8	2.5 - 6	9	1,100	0.97	2.13	1/4 F/Hex	1.37	1/4	0.51	18	78
TDCS-30S07	M5	26.4 - 70	3 - 8	9	700	0.97	2.13	1/4 F/Hex	1.37	1/4	0.51	18	78
TDCS-30S05	M6	30.8 - 88	3.5 - 10	9	500	0.97	2.13	1/4 F/Hex	1.37	1/4	0.51	18	78

Recommended Air Pressure : TDCS-08.10 : 70psi (5kg/cm2)/0.5MPa TDCS-20.30 : 85psi (6kg/cm2)/0.6MPa
Air Hose Size : 10mm×6.5mm×5m



TDCS-20S



TDCS-30S



TDCS-10S



TDCS-08S

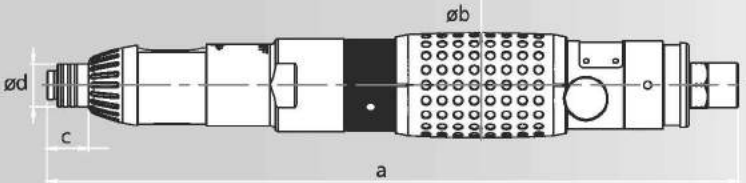

Dimensions				
Model	a (mm)	b (mm)	c (mm)	d (mm)
TDCS-08S	216.1	ø26	16	ø16
TDCS-10S	229.1	ø31.5	16	ø16
TDCS-20S	257	ø37.5	16	ø16
TDCS-30S	261	ø40.5	16	ø16

[Push Start]

[Lever Start]



TDCS-10SL TDCS-30SL

TDCS-08SL

TDCS-20SL



SPECIFICATIONS

Model	Screw Size	Torque Range		Bit Shank	Free Speed	Weight		Drive Size	Dia	Air Inlet	Average Air Consumption		Noise Level
	mm	in-lb	Nm	mm	rpm	kg	lb	inch	inch	inch	m³/min	ft³/min	dB(A)
TDCS-08SL15	M2	2.7 - 6.2	0.3 - 0.7	9	1,500	0.41	0.9	1/4 F/Hex	0.9	1/8	0.2	7	73
TDCS-08SL11	M2	3.5 - 8.8	0.4 - 1	9	1,100	0.41	0.9	1/4 F/Hex	0.9	1/8	0.2	7	73
TDCS-10SL16	M2-M3	6.2 - 12.3	0.7 - 1.3	9	1,600	0.63	1.4	1/4 F/Hex	1.1	1/8	0.35	12.5	75
TDCS-10SL09	M3	6.2 - 17.6	0.7 - 2	9	900	0.63	1.4	1/4 F/Hex	1.1	1/8	0.35	12.5	75
TDCS-20SL17	M3	8.8 - 26.4	1 - 3	9	1,700	1	2.2	1/4 F/Hex	1.37	1/4	0.47	16.5	78
TDCS-20SL11	M3-M4	8.8 - 30.8	1 - 3.5	9	1,100	1	2.2	1/4 F/Hex	1.37	1/4	0.47	16.5	78
TDCS-20SL07	M3-M4	8.8 - 35.2	1 - 4	9	700	1	2.2	1/4 F/Hex	1.37	1/4	0.47	16.5	78
TDCS-30SL17	M4	17.6 - 39.6	2 - 4.5	9	1,700	1	2.2	1/4 F/Hex	1.37	1/4	0.51	18	78
TDCS-30SL11	M4-M5	22 - 52.8	2.5 - 6	9	1,100	1	2.2	1/4 F/Hex	1.37	1/4	0.51	18	78
TDCS-30SL07	M5	26.4 - 70	3 - 8	9	700	1	2.2	1/4 F/Hex	1.37	1/4	0.51	18	78
TDCS-30SL05	M6	30.8 - 88	3.5 - 10	9	500	1	2.2	1/4 F/Hex	1.37	1/4	0.51	18	78

Recommended Air Pressure : TDCS-08.10 : 70psi (5kg/cm2)/0.5MPa TDCS-20.30 : 85psi (6kg/cm2)/0.6MPa
Air Hose Size : 10mm×6.5mm×5m

Dimensions

Model	a (mm)	b (mm)	c (mm)	d (mm)
TDCS-08SL	238	ø26	16	ø16
TDCS-10SL	246	ø31.5	16	ø16
TDCS-20SL	278	ø37.5	16	ø16
TDCS-30SL	274	ø40.5	16	ø16

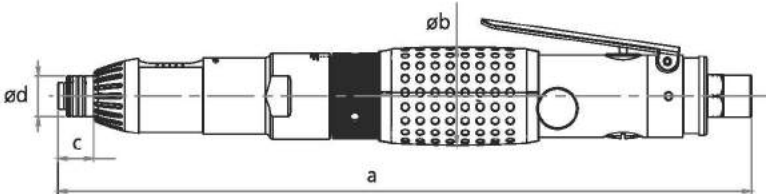

[Angle Type]



TDCS-08R

TDCS-10R

TDCS-20R

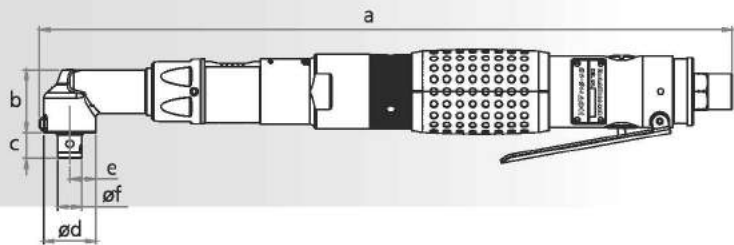

TDCS-30R

Dimensions

Model	a (mm)	b (mm)	c (mm)	d (mm)	e (mm)	f (mm)
TDCS-08R	284.1	30	11.5	ø24	12	ø11
TDCS-10R	290.5	30	11.5	ø24	12	ø11
TDCS-20R	320.6	30	11.5	ø24	12	ø11
TDCS-30R	328	30	17.5	ø27	13.5	ø11

SPECIFICATIONS

Model	Screw Size	Torque Range		Bit Shank	Free Speed	Weight		Drive Size	Dia	Air Inlet	Average Air Consumption		Noise Level
	mm	in-lb	Nm	mm	rpm	kg	lb	inch	inch	inch	m ³ /min	ft ³ /min	dB(A)
TDCS-08R15	M2	2.7 - 7	0.3 - 0.8	9	1,500	0.56	1.23	1/4 F/Hex	0.9	1/8	0.2	7	73
TDCS-08R11	M2	3.5 - 8.8	0.4 - 1	9	1,100	0.56	1.23	1/4 F/Hex	0.9	1/8	0.2	7	73
TDCS-10R16	M2-M3	6.2 - 12.3	0.7 - 1.3	9	1,600	0.8	1.8	1/4 F/Hex	1.1	1/8	0.35	12.5	75
TDCS-10R09	M3	6.2 - 17.6	0.7 - 2	9	900	0.8	1.8	1/4 F/Hex	1.1	1/8	0.35	12.5	75
TDCS-20R17	M3	8.8 - 25	1 - 2.8	9	1,700	1.2	2.64	1/4 F/Hex	1.37	1/4	0.47	16.5	78
TDCS-20R11	M3-M4	8.8 - 30	1 - 3.4	9	1,100	1.2	2.64	1/4 F/Hex	1.37	1/4	0.47	16.5	78
TDCS-20R07	M3-M4	8.8 - 40	1 - 4.5	9	700	1.2	2.64	1/4 F/Hex	1.37	1/4	0.47	16.5	78
TDCS-30R11	M4-M5	35.2 - 2.8	4 - 6	9	1,100	1.3	2.86	1/4 F/Hex	1.37	1/4	0.51	18	78
TDCS-30R07	M5	35.2 - 70	4 - 8	9	700	1.3	2.86	1/4 F/Hex	1.37	1/4	0.51	18	78
TDCS-30R05	M6	44 - 88	5 - 10	9	450	1.3	2.86	1/4 F/Hex	1.37	1/4	0.51	18	78

Recommended Air Pressure : TDCS-08.10 : 70psi (5kg/cm2)/0.5MPa TDCS-20.30 : 85psi (6kg/cm2)/0.6MPa
Air Hose Size : 10mm×6.5mm×5m

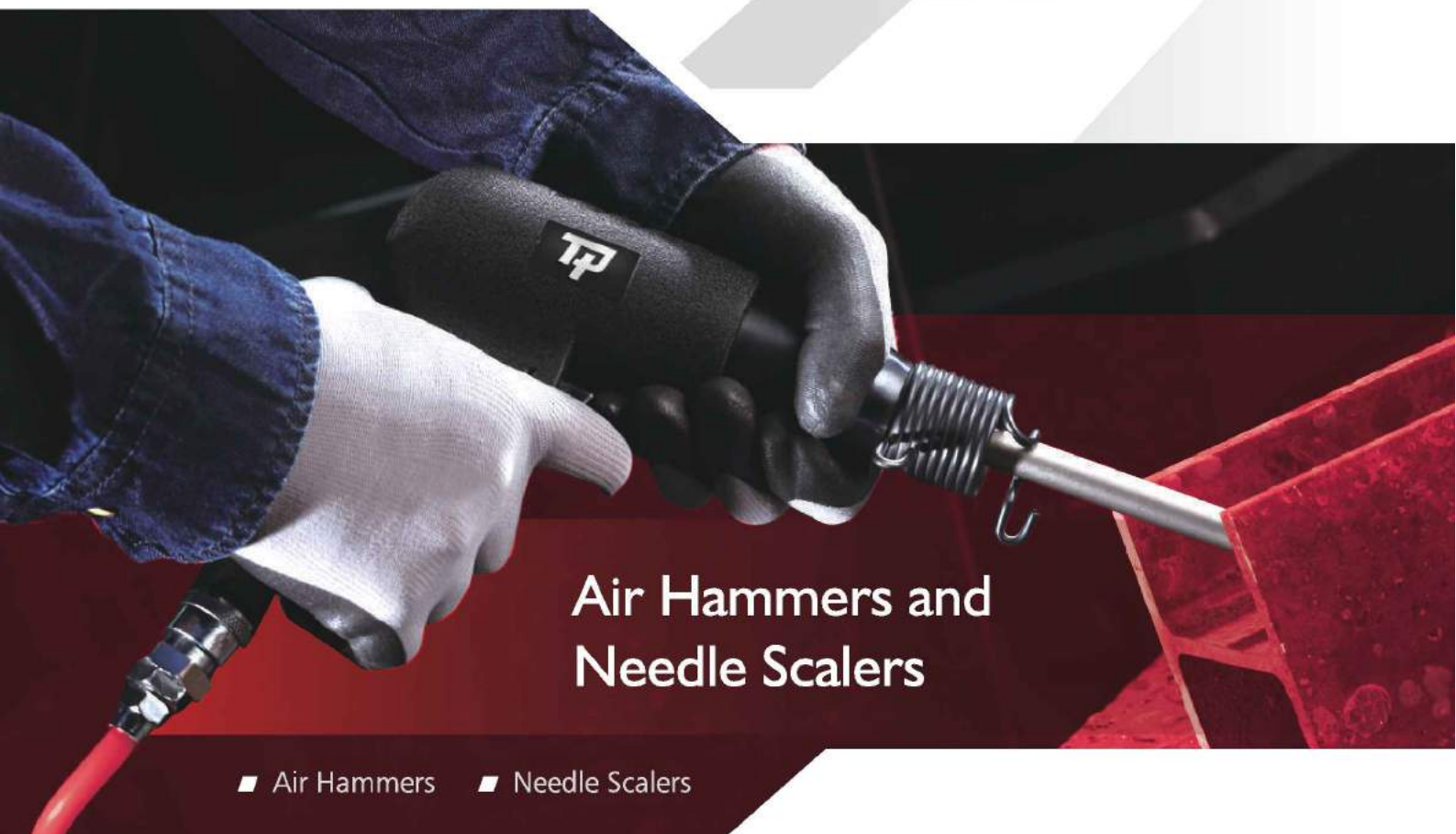

Air Hammers and Needle Scalers

■ Air Hammers ■ Needle Scalers

[Air Hammers]



TPT-684N
Air Hammer, includes
5-pcs chisel kit(175mm/Round)

TPT-684NH
Includes
5-pcs chisel kit(175mm/Hex)



TPT-685N
Air Hammer, includes
5-pcs chisel kit(250mm/Round)

TPT-685NH
Includes
5-pcs chisel kit(250mm/Hex)



TPT-686
Air Hammer, includes
5-pcs chisel kit(190mm/Round)

TPT-686H
Includes
5-pcs chisel kit(190mm/Hex)

Model	Shank Opening	Stroke Speed	Strok Length		Net Weight		Overall Length		Noise Level	Average Air Cons. @ Load		Air Inlet NPTF	Hose Size	
	in(mm)	bpm	in	mm	lb	kg	inch	mm	dBA	cfm	L/min	inch	inch	mm
TPT-684N	.401(10.2)	3,200	2.6	67	3.1	1.4	6.8	173	99	3.9	110	1/4	3/8	10
TPT-684NH	.401(10.2)hex	3,200	2.6	67	3.1	1.4	6.8	173	99	3.9	110	1/4	3/8	10
TPT-685N	.401(10.2)	2,100	3.5	89	3.7	1.7	8.8	223	99	3.9	110	1/4	3/8	10
TPT-685NH	.401(10.2)hex	2,100	3.5	89	3.7	1.7	8.8	223	99	3.9	110	1/4	3/8	10
TPT-686	.401(10.2)	3,000	2.4	60	3.3	1.5	7.9	200	95	9.5	270	1/4	3/8	10
TPT-686H	.401(10.2)hex	3,000	2.4	60	3.3	1.5	7.9	200	95	9.5	270	1/4	3/8	10

[Air Hammers]

**TPT-930**

Air Chipping Hammer

TPT-930H

with (0.58")14.7mm chisel, Hex

**TPT-932**

Air Chipping Hammer

TPT-932H

with (0.58")14.7mm chisel, Hex

**TPT-931**

Air Chipping Hammer

TPT-931H

with (0.58")14.7mm chisel, Hex

**TPT-928**

Air Scaling Hammer

**TPT-929**

Air Scaling Hammer

**TPT-919**

Air Riveting Hammer

Model	Shank Opening	Stroke Speed	Stroke Length		Net Weight		Overall Length		Noise Level	Average Air Cons. @ Load		Air Inlet NPTF	Hose Size	
	in(mm)	bpm	in	mm	lb	kg	inch	mm	dBA	cfm	L/min	inch	inch	mm
TPT-930	0.68(17.3)	2,400	3.0	77	17.6	8.0	14.4	365	104	33.9	960	1/4	3/8	10
TPT-930H	0.58(14.7) hex	2,400	3.0	77	17.6	8.0	14.4	365	104	33.9	960	1/4	3/8	10
TPT-931	0.68(17.3)	1,920	3.7	94	18.7	8.5	15.7	400	104	33.2	940	3/8	3/8	10
TPT-931H	0.58(14.7) hex	1,920	3.7	94	18.7	8.5	15.7	400	104	33.2	940	3/8	3/8	10
TPT-932	0.68(17.3)	1,550	4.0	102	19.8	9.0	16.7	425	104	30.4	860	3/8	3/8	10
TPT-932H	0.58(14.7) hex	1,550	4.0	102	19.8	9.0	16.7	425	104	30.4	860	3/8	3/8	10
TPT-928	-	7,000	1.5	38	5.1	2.3	22.0	560	101	5.0	141	1/4	3/8	10
TPT-929	-	2,400	1.0	26	8.8	4.0	21.7	550	104	11.5	326	3/8	3/8	10
TPT-919	8mm	5,400	1.2	31	0.9	0.4	6.7	170	96	3.0	85	1/4	3/8	10

[Needle Scalers]



TPT-921
Air Needle Scaler



TPT-922
Air Needle Scaler

Model	Needle Quantity	Stroke Speed	Needle Size		Net Weight		Overall Length		Noise Level	Average Air Cons. @ Load		Air Inlet NPTF	Hose Size	
	pcs	bpm	in	mm	lb	kg	inch	mm	dBA	cfm	L/min	inch	inch	mm
TPT-921	19	3,700	1/8	3	5.9	2.7	13.2	335	108	4.2	120	1/4	3/8	10
TPT-922	35	2,500	1/8	3	13.2	6.0	18.1	460	112	7.1	200	1/4	3/8	10
TPT-923	19	4,400	1/8	3	6.2	2.8	16.1	410	104	6.7	190	1/4	3/8	10
TPT-926	28	2,800	1/8	3	11.9	5.4	23.6	600	112	10.0	283	1/4	3/8	10
TPT-920	19	3,700	1/8	3	5.9	2.7	14.8	375	108	4.2	120	1/4	3/8	10



TPT-923
Air Needle Scaler

TPT-923F
Air Flux Chipper



TPT-926
Air Needle Scaler



TPT-920
Air Needle Scaler

[Needle Scalars]



TPT-924
Air Flux Chipper



TPT-925
Air Gasket Scraper



TPT-927-3L
23.6"(600mm) in length

TPT-927-4L
47.2"(1,200mm) in length

TPT-927-5L
59.1"(1,500mm) in length
Air Long Reach Scraper

Model	Stroke Speed	Stroke Length		Net Weight		Overall Length		Noise Level	Average Air Cons. @ Load		Air Inlet NPTF	Hose Size	
	bpm	in	mm	lb	kg	inch	mm	dBA	cfm	L/min	inch	inch	mm
TPT-924	2,700	1.3	33	4.8	2.2	13.2	335	107	5.0	141	1/4	3/8	10
TPT-925	4,000	1.6	40	1.8	0.8	9.6	245	91	3.5	100	1/4	3/8	10
TPT-927-3L	2,400	1.5	38	10.6	4.8	23.6	600	109	10.0	283	1/4	3/8	10
TPT-927-4L	2,400	1.5	38	14.3	6.5	47.2	1,200	109	10.0	283	1/4	3/8	10
TPT-927-5L	2,400	1.5	38	16.1	7.3	59.1	1,500	109	10.0	283	1/4	3/8	10

Special Tools

Riveters and Nut Setters
Caulking Guns
Grease Guns
Concrete Breakers



[Riveters and Nut Setters]



TPT-774

Air Nut Setter

Pulling Nut Size	Optional Pulling Nut				
	Steel	Aluminum	Steel	Aluminum	Steel
M3,M4	774-32M4	774-32M4	774-32M4	774-32M4	774-32M4
M5,M6	774-08M6	774-08M6	774-08M6	774-08M6	774-08M6
M8	774-04M8	774-04M8	774-04M8	774-04M8	774-04M8

Model	Pulling Size	Free Speed	Net Weight		Overall Length		Noise Level	Average Air Cons. @ Load		Air Inlet NPTF	Hose Size	
	mm	rpm	lb	kg	inch	mm	dBA	cfm	L/min	inch	inch	mm
TPT-774-32M4	M3. M4	3,200	2.6	1.2	7.0	177	87	8.8	250	1/4	3/8	10
TPT-774-08M6	M5. M6	800	3.1	1.4	7.7	195	87	8.8	250	1/4	3/8	10
TPT-774-04M8	M8	400	3.1	1.4	7.7	195	87	8.8	250	1/4	3/8	10



TPT-695

Air Hydraulic Riveter



TPT-696

Air Hydraulic Riveter

Model	Piston Stroke	Traction Power	Capacity		Net Weight		Overall Length		Noise Level	Average Air Cons. @ Load		Air Inlet NPTF	Hose Size	
	mm	Kg-f	in	mm	lb	kg	inch	mm	dBA	cfm	L/min	inch	inch	mm
TPT-695	16	850	3/32-3/16	2.4-4.8	3.3	1.5	10.7	273	71	0.04	1	1/4	3/8	10
TPT-696	16	1,250	5/32-1/4	4-6.4	4.0	1.8	11.7	298	77	0.06	2	1/4	3/8	10

[Caulking Guns]

TPT-670K
Air Wonder Gun Kit



TPT-646
Air Adjustable Caulking Gun



Model	Cartridge / Sachet	Net Weight		Overall Length		Noise Level	Average Air Cons. @ Load		Air Inlet NPTF	Hose Size	
	Capacity	lb	kg	inch	mm	dBA	cfm	L/min	inch	inch	mm
TPT-645	500ML / 310-600ML	2.6	1.2	15.2	386	70	2.0	57	1/4	1/4	6.4
TPT-646	310ML	2.4	1.1	12.0	305	70	4.0	113	1/4	3/8	10
TPT-670K	-	0.9	0.4	-	-	-	14.8	420	1/4	1/4	6.4



[Grease Guns]

TPT-645
Air Sprayer, Sealer & Caulking Gun



TKC-401
Air Continuous Grease Gun



TKC-500
Air Single Shot Grease Gun



TKC-505
Air Continuous Grease Gun

Model	Output Pressure	Capacity	Net Weight		Air Pressure		Air Inlet NPTF	Hose Size	
	PSI	cc (oz)	lb	kg	PSI	kg/cm2	inch	inch	mm
TKC-401	1,600-4,000	400 (14)	3.7	1.7	40-100	2.8-7	1/4	3/8	10
TKC-500	1,600-6,000	500 (16)	3.5	1.6	40-150	2.8-10.5	1/4	3/8	10
TKC-505	1,600-6,000	500 (16)	3.5	1.6	40-150	2.8-10.5	1/4	3/8	10

[Concrete Breakers]

TPT-10S
Air Concrete Breaker

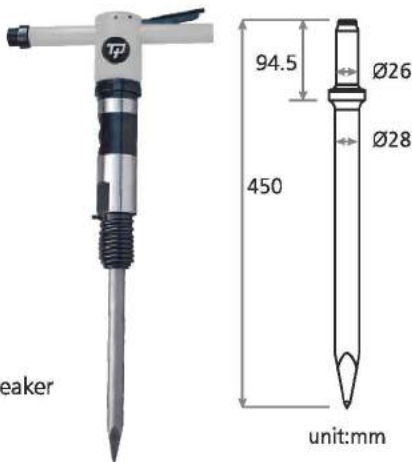

TPT-30S
Air Concrete Breaker



Model	Shank Opening	Stroke Speed	Strok Length		Net Weight		Overall Length		Noise Level	Average Air Cons. @ Load		Air Inlet NPTF	Hose Size	
	mm	bpm	in	mm	lb	kg	inch	mm	dBA	cfm	L/min	inch	inch	mm
TPT-10S	Round Ø26	1,300	5.9	151	31	14.1	29.6	753	104	35.02	991	1/2	1/2	13
TPT-30S	Round Ø30	1,000	9.3	235	54	24.6	34.6	880	104	42.01	1,189	1/2	3/4	19

[Accessories For TPT-10S/30S]



TPT-10S/30S-A
Unique Nut



TPT-10S18-B
1/2" & 3/4"
Hose Nipple



TPT-10S013-B
Retainer Spring
for TPT-10S



TPT-30S012-B
Hitch Cutter Retainer
for TPT-30S



TPT-609
Spot Weld Drill Kit with
Counter Arm



TPT-617
Punching and Welding Tool



TPT-643
Air Glass Removable Tool

Model	Free Speed	Bit Sizeze		Net Weight		Overall Length		Noise Level	Average Air Cons. @ Load		Air Inlet NPTF	Hose Size	
	rpm	mm		lb	kg	inch	mm	dBA	cfm	L/min	inch	inch	mm
TPT-609	1,600	Ø8	Ø6.5	4.4	2.0	9.3	235	86	6.0	170	1/4	3/8	10

Model	Capacity	Punch Size	Flange Width	Net Weight		Overall Length		Noise Level	Average Air Cons. @ Load		Air Inlet NPTF	Hose Size	
	mm	mm	mm	lb	kg	inch	mm	dBA	cfm	L/min	inch	inch	mm
TPT-617	1.2(steel)/1.6(Al)	Ø5	Ø12	2.9	1.3	9.8	248	70	0.03	0.8	1/4	3/8	10

Model	Free Speed	Net Weight		Overall Length		Noise Level	Average Air Cons. @ Load		Air Inlet NPTF	Hose Size	
	rpm	lb	kg	inch	mm	dBA	cfm	L/min	inch	inch	mm
TPT-643	20,000	2.2	1.0	7.9	200	80	3.0	85	1/4	3/8	10



[Digital Torque Wrenches]



GRAVITY

It is more precise to make the calibration in the Calibration Lab. after measuring the gravity by Taiwan National Science Council.

ISO 17025

Every torque wrench in DTW series is tested in the Calibration Lab. Complies with the ISO: 17025.



THE CALIBRATION MACHINE

Every torque wrench has been approved by the Calibration Lab. And the test report is Internationally valid, which is granted by laboratories in numerous countries.



Calibration Laboratory

Calibration Laboratory

The Calibration Lab. is one of the members of Taiwan Accreditation Foundation (TAF).

Model	SQ.Drive	Nm	Ft-lbs	In-lbs	Kgm	Length (mm)	Weight (kg)
DTW-3135	3/8"	10-135	7.4-99.6	89-1,198	1-13.7	400	1.2
DTW-4135	1/2"	10-135	7.4-99.6	89-1,198	1-13.7	400	1.2
DTW-3200	3/8"	20-200	14.8-147	178-1,780	2-20.4	570	1.6
DTW-4200	1/2"	20-200	14.8-147	178-1,780	2-20.4	570	1.6
DTW-4340	1/2"	34-340	25-250.9	303-3,010	3.5-34.7	770	2

Accuracy	CW±2% +1 LSD/CCW±3% +1 LSD
Direction	Clockwise/Counter-clockwise
Torque Unit	Nm/Ft-lbs/In-lbs/Kgm
Battery	9V(Alkaline) x1
Operation Temperature	5~ 42 °C, 40~ 107 °F
Storage Temperature	-20~ 50 °C, -4~ 107 °F
Power	Auto shutdown after 90 seconds idle



Every torque wrench in DTW series complies with ISO:6789 and must pass 100% strict quality inspection and test.

Accessories

[Maintenance Parts]



Model	Port Size	Filter Element	Adjustment Pressure	Max Service Pressure	Max Flow	Drain Capacity	Oil Capacity
	inch	μ	kg/cm2	kg/cm2	L/min	ml	ml
TPA-804FRL	1/4, 3/8, 1/2	20	0.5 - 9.9	15	1,750-2,200	80	125
TPA-202FRL	1/4	20	0.5 - 9.9	10	1,100	15	30

Model	Port Size	Nozzle Length	Max Pressure	
	inch	cm	PSI	kg/cm2
TPA-B20	1/4	30	200	14
TPA-B25	1/4	85	200	14



PROFESSIONAL POWER TOOLS

For over 30 years, Tranmax has devoted itself to manufacturing and providing high quality products and service for professional applications. Our diverse and innovative product range has successfully fulfilled customers' needs and persistently meets market trends and demands. To learn more about Tranmax products, please visit [www. Tranmax.com](http://www.Tranmax.com)



TRANMAX
Tranmax Machinery

Tranmax Machinery Co., Ltd.

No. 130 Renhuagong 1st Road, Dali Dist,
Taichung City 412, Taiwan, R.O.C
Tel: +886-4-2495 2609 Fax: +886-4-2495 2647